

# ESCAPE ROUTE SIGN FOR RECESSED MOUNTING STELAR-V

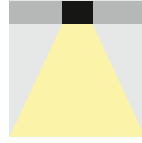

← → 30m



- Exclusive design orientated ceiling recessed mounting escape route sign fixture
- Either non-maintained/ maintained (NM/M) or centralised (C) emergency lighting available in all following versions:
  - **AUTOTEST** (-AT)
  - **DALI**
  - **CENTRALTEST** (-ATXL) for ELMAX LOOK system (look up also page No.22)
  - **Wireless CENTRALTEST** (-ATRF) for ELMAX-ATRF system (page No.24)
  - **CENTRAL BATTERY** (C.STELAR) for **non-addressable CBS**
- Conforming to the requirement of EN60598-2-22, EN1838, EN62034
- Design:
  - plastic body in white with "click" mounting springs
  - plexi diffuser with a legend / picto (must be ordered separately)
- Elegatné dizajnové stropné núdzové svietidlo pre označenie smeru úniku rčené pre zapustenú montáž do stropu
- Pre netrvalé/trvalé (NM/M) alebo (C) centrálné napájané núdzové osvetlenie dostupné vo verziách:
  - **AUTOTEST** (-AT)
  - **DALI**
  - **CENTRALTEST** (-ATXL) pre systém ELMAX LOOK (pozri str.22)
  - **bezdrôtový CENTRALTEST** (-ATRF) pre ELMAX-ATRF systém (str.24)
  - **CENTRAL BATTERY** (C.STELAR) pre **neadresovateľné CBS**
- spĺňa požiadavky európskej normy EN 60598-2-22, EN1838, EN62034
- konštrukcia:
  - plastové teleso s pružinami na jednoduchú montáž do stropu
  - závesné plexi s piktogramom (musí byť objednané samostatne podľa požadovaného typu piktó)

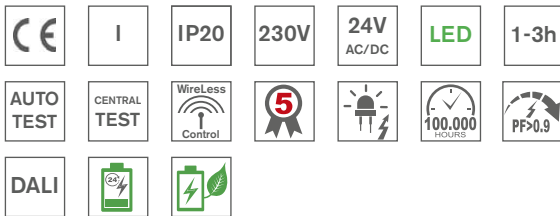

#### Input Power:

- 4,6W/ 5,4VA (maintained M/1h)
- 2,2W/ 4,3VA (non-maintained NM/1h)
- 2,7W/ 4,6VA (CBS)

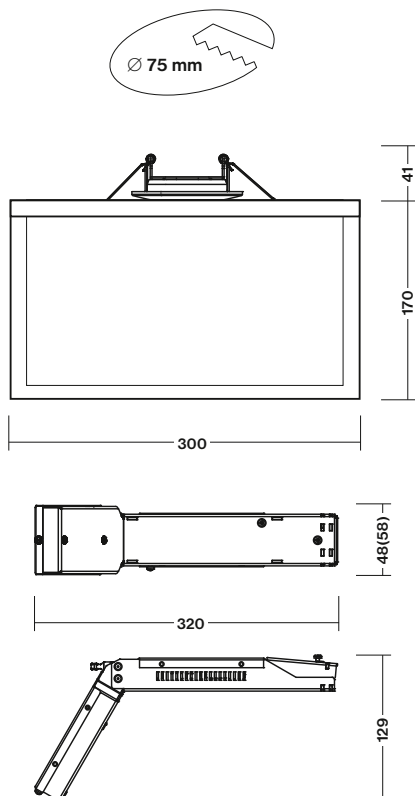

\* Dimmensions in the bracket are valid for 3h versions  
\* rozmery v zátvorke platia pre 3h verzie

#### STANDARD FEATURES

#### STANDARDNÁ VÝBAVA

- **High efficient (170lm/W, 5000K) LONGLIFE LEDs (>100.000h)**
- **NEW Advanced Electronics**
- **LONGLIFE LiFePo4 battery**
- **Installation Mode** (battery protection, for more details look up page No.28)
- **Intelligent battery charging**
- Special layered suspended legend for perfect smooth pictogram illumination
- Addressable CENTRALTEST communication module (for ATXL, ATRF only)
- LEDs indicating presence of power supply and signaling failures & TEST button
- **vysoko účinné LED (170lm/W, 5000K) so životnosťou min.100000h**
- **progresívna elektronická jednotka**
- **LONGLIFE LiFePo4 batéria**
- **Inštaláčny mód** (ochrana batérie, pozri aj str.28)
- **Inteligentné nabíjanie batérie**
- špeciálne vrstvené závesné plexi pre perfektné rovnomerné osvetlenie piktogramu
- adresovateľný CENTRALTEST komunikačný modul (len pre ATXL, ATRF verzie)
- signalizácia LED a TEST tlačítko

#### OPTIONAL ACCESSORIES

#### PRÍPLATKY

- **Special suspended plexi with layered design for perfect uniform illumination of legend - must be ordered as a separate item (look up also page No.112)**
- Alternative plastic body colour: grey or black (MOQ 50pcs)
- **špeciálne vrstvené závesné plexi pre rovnomerné osvetlenie piktogramu na jeho celej ploche (plexi musí byť objednané samostatne podľa želaného piktogramu- pozri aj str.112)**
- farba telesa svietidla v šedej alebo čiernej (objednávka min 50ks)

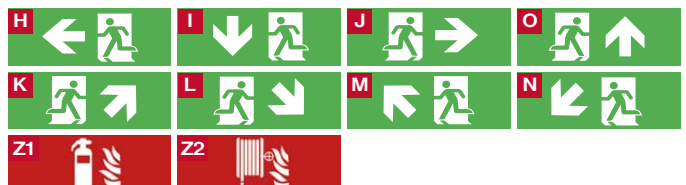



- Cut the mounting hole size 75mm in diameter
  - Connect the mains
  - CLICK the fixture in the hole
- vyrež montážny otvor 75mm priemer
  - pripoj sieťové vodiče
- následne "NA-KLIKNI" svietidlo do otvoru



Page No.18

**AUTOTEST -AT NM/M**

Type	Version	Light Source	Battery	Order Code	Weight
STELAR-V-AT.1h	Only body, plexi is separete	HighPower LED	LiFePo4 6,4V/1,0Ah	345-B-001-04-00-01	0,6 kg
STELAR-V-AT.3h	Only body, plexi is separete	HighPower LED	LiFePo4 6,4V/2,0Ah	345-B-002-04-00-01	0,7 kg

**DALI SELF-CONTAINED**

Type	Version	Light Source	Battery	Order Code	Weight
STELAR-V-DALI.1h	Only body, plexi is separete	HighPower LED	LiFePo4 6,4V/1,0Ah	345-B-004-04-00-01	0,6 kg
STELAR-V-DALI.3h	Only body, plexi is separete	HighPower LED	LiFePo4 6,4V/2,0Ah	345-B-005-04-00-01	0,7 kg

Page No.22

**CENTRALTEST -ATXL ELMAX-LOOK**

Type	Version	Light Source	Battery	Order Code	Weight
STELAR-V-ATXL.1h	Only body, plexi is separete	HighPower LED	LiFePo4 6,4V/1,0Ah	345-B-006-04-00-01	0,6 kg
STELAR-V-ATXL.3h	Only body, plexi is separete	HighPower LED	LiFePo4 6,4V/2,0Ah	345-B-007-04-00-01	0,7 kg

Page No.24

**Wireless CENTRALTEST ELMAX-ATRF**

Type	Version	Light Source	Battery	Order Code	Weight
STELAR-V-ATRF.1h	Only body, plexi is separete	HighPower LED	LiFePo4 6,4V/1,0Ah	345-B-008-04-00-01	0,7 kg
STELAR-V-ATRF.3h	Only body, plexi is separete	HighPower LED	LiFePo4 6,4V/2,0Ah	345-B-009-04-00-01	0,6 kg

**CENTRAL BATTERY (CBS)**

Type	Version	Version	Light Source	Order Code	Weight
C.STELAR-V 230V AC/DC	Only body, plexi is separete	CBS NON-ADDRESSABLE	HighPower LED	345-B-010-00-00-01	0,5 kg
C.STELAR-V 24V AC/DC	Only body, plexi is separete	CBS NON-ADDRESSABLE	HighPower LED	345-B-011-00-00-01	0,5 kg

**DALI CENTRAL BATTERY (CBS)**

Type	Version	Version	Light Source	Order Code	Weight
C.STELAR-V-DALI 230V AC	Only body, plexi is separete	DALI CBS	HighPower LED	345-B-012-00-00-01	0,5 kg



• It is not included in standard package.  
It must be ordered as separate item !

- Viewing Distance: 30m
- Complying ISO7010
- Legend luminance >500cd/m<sup>2</sup> (white)

• Nie je súčasťou štandardného balenia svetidla.  
Musí byť objednané ako samostatná položka !

- rozoznateľnosť piktogramu: 30m
- v súlade s ISO7010
- jas piktogramu >500cd/m<sup>2</sup> (biela)

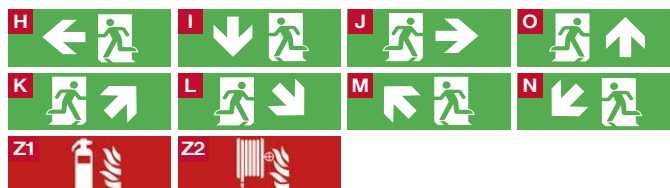

### Suspended plexi Accessory

Optional Item / Príplatok	Order Code / Objednávaci kód
Double sided plexi with legend H/J	345-B-000-02-00-01
Double sided plexi with legend I	345-B-000-02-00-02
Single sided plexi with legend H	345-B-000-01-00-03
Single sided plexi with legend I	345-B-000-01-00-04
Single sided plexi with legend J	345-B-000-01-00-05
Double sided plexi with legend K/M	345-B-000-02-00-06
Double sided plexi with legend L/N	345-B-000-02-00-07
Single sided plexi with legend K	345-B-000-01-00-08
Single sided plexi with legend L	345-B-000-01-00-09
Single sided plexi with legend M	345-B-000-01-00-10
Single sided plexi with legend N	345-B-000-01-00-11
Single sided plexi with legend O	345-B-000-01-00-12
Double sided plexi with legend O	345-B-000-02-00-13
Double sided plexi with legend Z1	345-B-000-02-00-14
Double sided plexi with legend Z2	345-B-000-02-00-15

### Závesné plexi s piktogramom

Príplatok	Objednávaci kód
Obojstranné plexi s piktogramom H/J	345-B-000-02-00-01
Obojstranné plexi s piktogramom I	345-B-000-02-00-02
Jednostranné plexi s piktogramom H	345-B-000-01-00-03
Jednostranné plexi s piktogramom I	345-B-000-01-00-04
Jednostranné plexi s piktogramom J	345-B-000-01-00-05
Obojstranné plexi s piktogramom K/M	345-B-000-02-00-06
Obojstranné plexi s piktogramom L/N	345-B-000-02-00-07
Jednostranné plexi s piktogramom K	345-B-000-01-00-08
Jednostranné plexi s piktogramom L	345-B-000-01-00-09
Jednostranné plexi s piktogramom M	345-B-000-01-00-10
Jednostranné plexi s piktogramom N	345-B-000-01-00-11
Jednostranné plexi s piktogramom O	345-B-000-01-00-12
Obojstranné plexi s piktogramom O	345-B-000-02-00-13
Obojstranné plexi s piktogramom Z1	345-B-000-02-00-14
Obojstranné plexi s piktogramom Z2	345-B-000-02-00-15



- You can create homogenous emergency lighting design by using of combination of STELAR3 and LEDLUX-SPOT3-V fixtures. All of them are based on the same design.
- **LEDLUX-SPOT3-A-V** fixtures are designed for escape corridor / route illumination (for more details please refer to page No.120 / pozri aj str.120)
- **LEDLUX-SPOT3-B-V** fixtures are designed for open areas, anti-panic lighting (for more details please refer to page No.124 / pozri aj str.124)

