

## INSTALLATION INSTRUCTION

### TRACKLUX-A/B-AT+2xLED.1H/3H

This luminaire is intended for emergency illuminance of escape ways and illuminance of the safety mark for the emergency escape ways (in administrative buildings, business centers, theatres, schools, hospitals, industrial objects etc.).

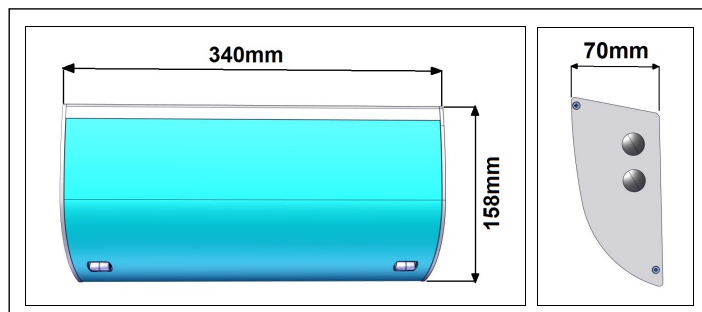

#### VERSIONS



#### INSTALLING THE LUMINAIRE

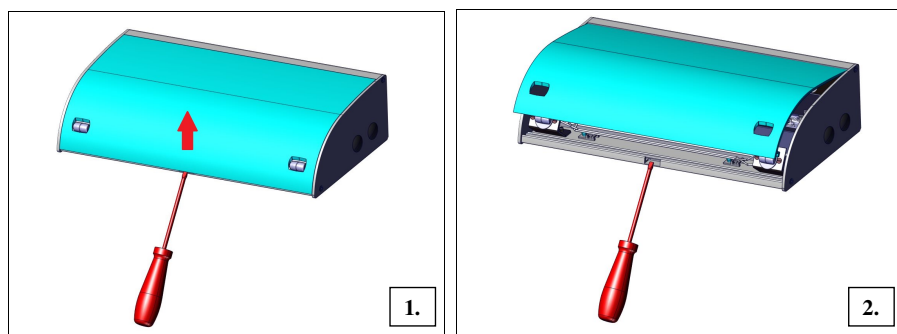

## INSTALLATION INSTRUCTION

### TRACKLUX-A/B-AT+2xLED.1H/3H

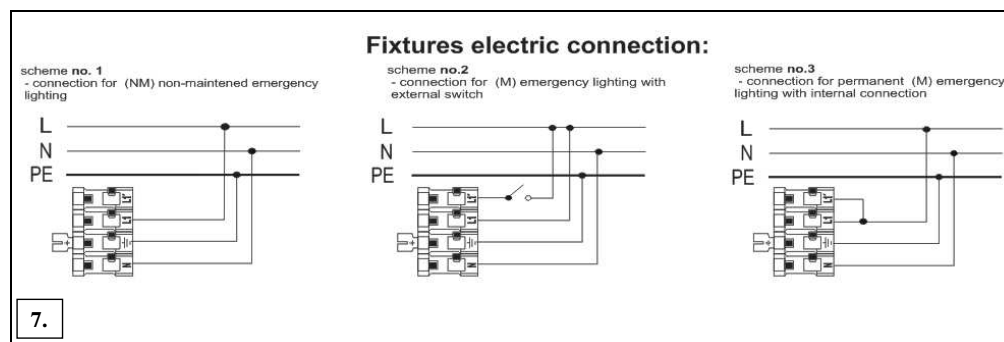
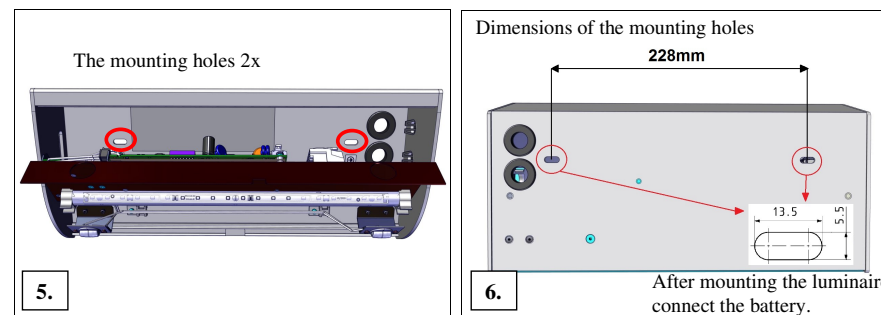
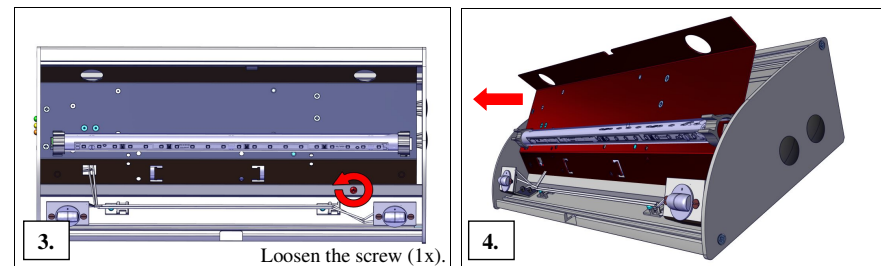

# INSTALLATION INSTRUCTION

## TRACKLUX-A/B-AT+2xLED.1H/3H

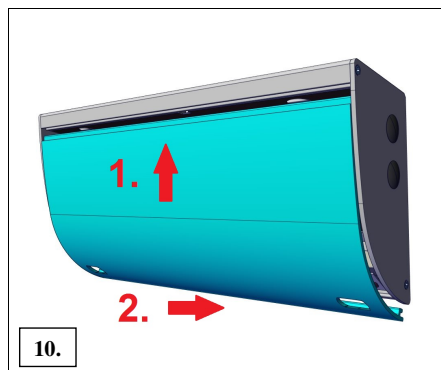
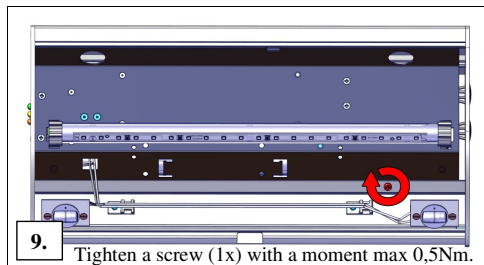
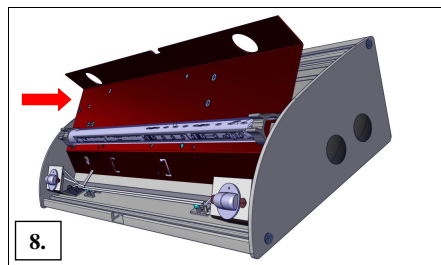

### STANDARD FEATURES

Self-adhesive legends (use as needed).



A symbol on the product or its packaging indicate that this product should not go into household waste. It must be taken to the collection point of an electric and electronic equipment recycling facility. By making sure this product is disposed of properly, you will help prevent the negative effects on the environment and human health that would otherwise result from inappropriate disposal of this product.

### BATTERY REPLACEMENT

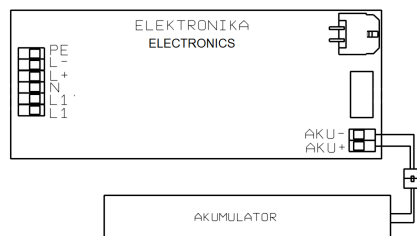

# INSTALLATION INSTRUCTION

## TRACKLUX-A/B-AT+2xLED.1H/3H

### EMERGENCY LUMINAIRE SETTING OPTIONS

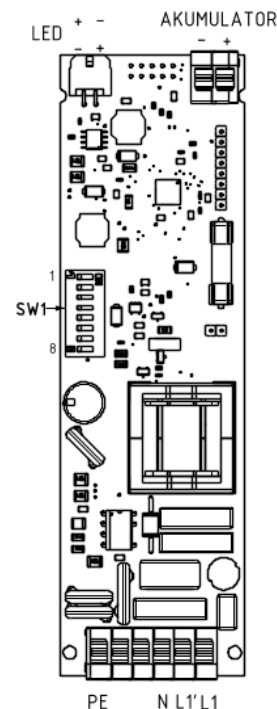

Switch setting options SW1:

SW1	FUNCTION DESCRIPTION	POSITION	
		OFF	ON
1	Activation of 2xLED in maintained mode	2xLED OFF	2xLED ON
2	Setting of the light output in maintained mode	See DIMMING TABLE	
3	Setting of the light output in emergency mode	>200cd/m average (50%)	>2cd/m - ECO MODE (10%)
4	Installation mode	ACTIVATED	DEACTIVATED
5	CONTROL of Luminaire	STAND ALONE -AT	CENTRALTEST- ATXL
6	MAINTAINED MODE	DEACTIVATED	ACTIVATED
7	-	-	-
8	-	-	-

DIMMING TABLE:





SW1			LIGHT OUTPUT - MT MODE		LIGHT OUTPUT - EMERGENCY MODE	
1	2	3	PICTOGRAM	+2xLED	PICTOGRAM	+2xLED
OFF	OFF	OFF	100% (PF>0.9)	OFF	50% or 10% - according setting dip switch SW1-4.	100%
OFF	OFF	ON	50%	OFF		
OFF	ON	OFF	25%	OFF		
OFF	ON	ON	10% ECO MODE	OFF		
ON	OFF	OFF	100% (PF>0.95)	100%		
ON	OFF	ON	50%			
ON	ON	OFF	25%			
ON	ON	ON	10% ECO MODE			

**NOTE: to activate the new switch settings you must push the test button or disconnect the luminaire from Mains and battery.**

# INSTALLATION INSTRUCTION

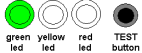
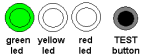
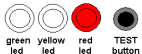
## TRACKLUX-A/B-AT+2xLED.1H/3H

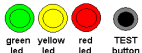
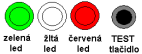
### STATUS MONITOR (3xLED - GREEN, YELLOW, RED and TEST BUTTON)

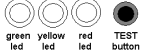
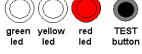
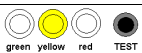
<b>Normal operation mode</b> <b>(Green LED is ON)</b>		<p>Fixture is connected to mains and battery charging is in operation.</p> <p>Fixture switches to this mode after 24hours continuous battery charging.</p>
<b>Installation mode</b> <b>(Green LED is flashing)</b>		<p>New fixture is in Installation mode, after 24hours continuous battery charging fixture switches to Normal mode.</p> <p>Fixture switches to Installation mode again when TEST button is pressed more than 5 second (reset battery failure) after battery was changed due to the failure Autonomy test (Battery failure).</p> <p>During installation mode fixture doesn't switch to the emergency mode after mains failures. Fixture switch to the Sleep mode.</p>
<b>Sleep mode</b> <b>(Red LED shortly blink each second)</b>		<p>Fixture is waiting for mains connection.</p> <p>Fixture switch to the Sleep mode when mains is not present (Emergency mode is running) and battery voltage drops below 4V.</p> <p>Fixture switch to this mode also when the fixture is in Installation mode and the mains is not present.</p>
<b>AUTO-TEST in progress</b> <b>(Yellow LED is flashing)</b>		<p>Fixture switch to AUTO-TEST mode by itself two times per month (Functional test) and two times per year (Autonomy test).</p> <p>Fixture switch to manual Functional test by short pressing of TEST button</p> <p>Fixture switch to manual Functional test by pressing and holding TEST button more than 5 second. (Using for reset battery failure).</p> <p>Fixture switch to manual Autonomy test by pressing and holding TEST button more than 10 second.</p>
<b>Rejection manual autonomy test</b> <b>(All LEDs blinks 3 times)</b>		<p>Fixture switch to manual Autonomy test by pressing and holding TEST button more than 10 second, if fixture is in Installation mode, manual Autonomy test is denied.</p> <p>Fixture switch to manual Autonomy test by pressing and holding TEST button more than 10 second, if fixture has delayed Autonomy AUTO-TEST, manual Autonomy test is denied.</p>
<b>Lighting source failure</b> <b>(Green and Red LEDs are ON)</b>		<p>Light source is defect (fluorescent tube or POWER LEDs).</p>
<b>Battery failure</b> <b>(Green and Yellow LEDs are ON)</b>		<p>Fixture switch to Battery failure mode after a failed autonomy test.</p>
<b>Emergency mode</b> <b>(All LEDs are OFF)</b>		<p>Fixture switch to emergency mode in case of mains failure.</p>
<b>Virtual address mode</b> <b>(Red LED is flashing)</b>		<p><b>In case ATXL version:</b></p> <ul style="list-style-type: none"> <li>- Fixture is ready/waiting for connection to CENTRALTEST ELMAX LOOK SYSTEM.</li> <li>- Fixture is not yet recognized by ELMAX LOOK SYSTEM.</li> </ul> <p><b>In case ATZB version:</b></p> <ul style="list-style-type: none"> <li>- Fixture is not joined to wireless network, insufficient signal intensity.</li> </ul>
<b>Received data from ELMAX SYSTEM</b> <b>(Yellow LED shortly blink)</b>		<p>In case ATXL / ATZB versions, if fixture receives data correctly from CENTRALTEST ELMAX SYSTEM then yellow LED shortly blinks.</p>