

## C.PRIMALUX / MULTIPRIMA LED

Exclusive modern unobtrusive design based on high quality aluminum frame which enhances aesthetic and functional aspects of PRIMALUX type series. Combined with the qualities of an innovative LED light source - extra-long service life at constant light output - this escape sign luminaire boasts a special talent for low operating costs. The luminaire proves its application flexibility with its range of installation options.

Exkluzívny moderný nenápadný design vychádzajúci z kvalitného materiálu hliníkového rámu, ktorý ešte viac prehĺbuje estetické a funkčné vlastnosti svetidiel typovej rady PRIMALUX. V kombinácii s kvalitami inovatívneho LED svetelného zdroja - extra dlhá životnosť pri konštantnom svetelnom výkone - sa môže toto núdzové svetidlo pochváliť špeciálnym talentom pre nízke prevádzkové a servisné náklady. PRIMALUX dokazuje svoju aplikačnú flexibilitu vďaka širokej typovej rade s rôznymi inštaláčnymi možnosťami.

Light source	LED 5000K >500cd/m <sup>2</sup> (white luminance) >200cd/m <sup>2</sup> (average luminance)
Installed load	5.8W/6.1VA (maintained M) 2.0W/3.9VA (non-maintained NM) 6.1W/6.3VA (CBS)
Frame cover material	Anodised aluminum
Viewing distance	30m
Application	Escape route lighting
Max luminaire spacing	up to <b>18m &gt; 1lx</b>
Application	Anti-panic lighting
Max room illumination	up to <b>86m<sup>2</sup> &gt; 0.5lx</b>



C.PRIMALUX / MULTIPRIMA-A  
(Page No.216)

### C.PRIMALUX-A / MULTIPRIMA-A escape sign luminaire

- Wall mounting escape sign LED emergency luminaire in accordance with EN1838
- Perfect uniform pictogram illumination
- Viewing distance: 30m
- núdzové svetidlo pre montáž na stenu v súlade s EN1838
- perfektná rovnomernosť osvetlenia piktogramu
- rozoznateľnosť piktogramu: 30m



C.PRIMALUX / MULTIPRIMA-A+2xLED  
(Page No.216)

### C.PRIMALUX-A+2xLED / MULTIPRIMA-A+2xLED

escape sign & escape route lighting (with 2 bottom HighPower LEDs)

- Wall mounting escape sign LED emergency luminaire in accordance with EN1838
- The additional bottom HighPower LEDs turn this fixture into escape sign and escape route/ anti-panic emergency lighting 2in1
- Perfect uniform pictogram illumination
- Maximum luminaire spacing: look up the page No.400
- Viewing distance: 30m
- núdzové svetidlo pre montáž na stenu v súlade s EN1838
- verzia s prídavnými spodnými HighPower LED je perfektnou kombináciou svetidiel na vyznačenie smeru / osvetlenie únikovej cesty a anti-panic svetidla
- perfektná rovnomernosť osvetlenia piktogramu
- maximálny rozstup svetidiel: pozri str. 400
- rozoznateľnosť piktogramu: 30m



C.PRIMALUX / MULTIPRIMA-AP  
(Page No.222)



C.PRIMALUX / MULTIPRIMA-APA  
(Page No.222)



C.PRIMALUX / MULTIPRIMA-APB  
(Page No.222)

### C.PRIMALUX-AP/-AV/+2xLED MULTIPRIMA-AP/-AV/+2xLED

escape sign & escape route lighting / anti-panic lighting (with additional 2 bottom HighPower LEDs)

- Ceiling mounting double sided escape sign LED emergency luminaire in accordance with EN1838
- The additional bottom HighPower LEDs turn this fixture into escape sign and escape route/anti-panic emergency lighting 2in1
- Perfect uniform pictogram illumination
- Maximum luminaire spacing : up to 18m >1lx
- Maximum room illumination: up to 86m<sup>2</sup> >0.5lx
- Viewing distance: 30m
- núdzové svetidlo pre montáž na strop s obojstranným piktogramom v súlade s EN1838
- verzia s prídavnými spodnými HighPower LED je perfektnou kombináciou svetidiel na vyznačenie/ osvetlenie smeru únikovej cesty a anti-panic núdzového svetidla
- perfektná rovnomernosť osvetlenia piktogramu
- maximálny rozstup svetidiel: až 18m >1lx
- maximálna plocha osvetlenia: až 86m<sup>2</sup> >0.5lx
- rozoznateľnosť piktogramu: 30m



C.PRIMALUX / MULTIPRIMA-AV  
(Page No.228)



C.PRIMALUX / MULTIPRIMA-AVA  
(Page No.228)



C.PRIMALUX / MULTIPRIMA-AVB  
(Page No.228)

**C.PRIMALUX-AP  
MULTIPRIMA-AP**

escape sign &  
escape route lighting &  
anti-panic lighting  
(with additional 2 bottom HighPower LEDs)

All ceiling mounting types can be equipped with optional wire rope suspension set suitable for higher ceiling application. The wire rope suspension set must be ordered as separate item.

Všetky PRIMALUX-AP LED núdzové svietidlá s montážou na strop môžu byť vybavené lankovým závesným setom pre montáž v priestoroch s vyššou vnútornou výškou stropu. Závesná sada musí byť objednaná ako samostatná položka, ktorá sa montuje na štandardné svietidlo.



C.PRIMALUX / MULTIPRIMA-AP  
+ wire suspension set  
(Page No.223)

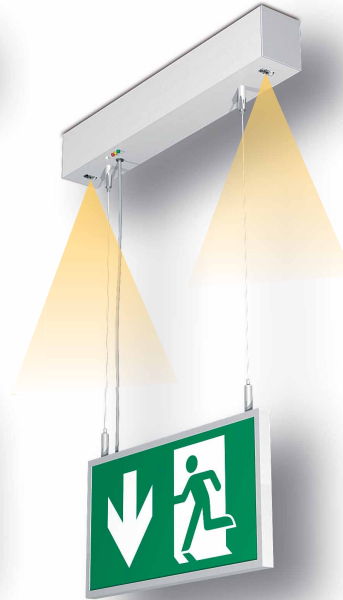

C.PRIMALUX / MULTIPRIMA-APA  
+ wire suspension set  
(Page No.223)



C.PRIMALUX / MULTIPRIMA-APB  
+ wire suspension set  
(Page No.223)

**C.PRIMALUX-AV  
MULTIPRIMA-AV**

escape sign &  
escape route lighting &  
anti-panic lighting  
(with 2 bottom HighPower LEDs)

All recessed mounting types can be equipped with the optional wire rope suspension set suitable for higher ceiling application. The wire rope suspension set must be ordered as separate item.

Všetky PRIMALUX-AV LED núdzové svietidlá s montážou do stropu môžu byť vybavené lankovým závesným setom pre montáž v priestoroch s vyššou vnútornou výškou stropu. Závesná sada musí byť objednaná ako samostatná položka, ktorá sa montuje na štandardné svietidlo.



C.PRIMALUX / MULTIPRIMA-AV  
+ wire suspension set  
(Page No.229)



C.PRIMALUX / MULTIPRIMA-AVB  
+ wire suspension set  
(Page No.229)



C.PRIMALUX / MULTIPRIMA-AVB  
+ wire suspension set  
(Page No.229)

## C.PRIMALUX-LED / MULTIPRIMA-LED

Available in black RAL9005 colour

Order code on demand

Dostupné aj čiernej farbe RAL9005

obj.kód ba požiadanie



← → 30m/60m

MULTIPRIMA-A / -B



← → 30m

MULTIPRIMA-A+2xLED

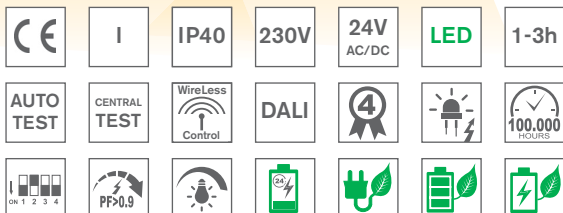

### Input Power:

- 5,8W/ 6,1VA (maintained M)
- 2,0W/ 3,9VA (non-maintained NM)
- 6,1W/ 6,3VA (CBS)

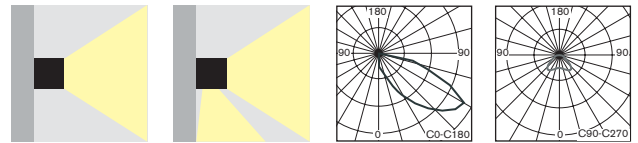

- Exclusive slim design surface mounted fixture for non-maintained/maintained (NM/M) or centralised (C) emergency lighting available in all following versions:
  - **AUTOTEST** (-AT) or **DALI**
  - **CENTRALTEST** (-ATXL) for ELMAX LOOK system (look up also page No.166)
  - **Wireless CENTRALTEST** (-ATZB) for ELMAX-ATZB system (page No.172)
  - **CENTRAL BATTERY** (C.PRIMALUX) for **non-addressable CBS** (look up also page No.178)
  - **CENTRAL BATTERY** (-ATXP) for system **ELMAX-PATROLUX & Addressable CBS** (look up also page No.174)
- Conforming to the requirement of EN60598-2-22, EN1838, EN62034
- Design:
  - Metal sheet base painted in RAL9003 colour
  - Acrylic layered diffuser with legend in anodised AL frame
- "štíhle" elegantné núdzové svietidlo pre trvalé/netrvalé (NM/M) alebo (C) centrálné napájané núdzové osvetlenie dostupné vo verziách pre:
  - **AUTOTEST** (-AT) alebo **DALI**
  - **CENTRALTEST** (-ATXL) pre systém ELMAX LOOK (pozri str.166)
  - **bezdrôtový CENTRALTEST** (-ATZB) pre ELMAX-ATZB systém (str.168)
  - **CENTRAL BATTERY** (C.PRIMALUX) pre **neadresovateľné CBS** (str.174)
  - **CENTRAL BATTERY** (-ATXP) pre systém **ELMAX-PATROLUX s adresovateľnou CBS** (pozri str. 170)
- spĺňa požiadavky európskej normy EN 60598-2-22, EN1838, EN62034
- konštrukcia:
  - základňa z ocelového plechu v bielej farbe RAL9003
  - svetelno-činný kryt z vrstveného plexi v ráme z eloxovaného hliníku

### STANDARD FEATURES

### ŠTANDARDNÁ VÝBAVA

- **High efficient (150lm/W, 5000K) LONGLIFE LEDs (>100.000h)**
- **2pcs of High-Power bottom LEDs** 120lm/W for floor escape root illumination (valid only for all "+2xLED" versions)
- **NEW Advanced Electronics**
- **LONGLIFE NiMh or LiFePo4 battery**
- **Installation Mode** (battery protection, for more details look up page No.181+218)
- **Intelligent battery charging** (intermittent charging, look up page No.181+218)
- **DIP Switch** allowing to preset following functions:
  - **ECO Mode** (dimming 10%-100%, for more details look up page No.181+218)
  - **ENERGY Saving Mode** (picto illumination 2cd/m<sup>2</sup> or 200cd/m<sup>2</sup>, look up page 181)
  - **2 bottom LEDs control** (ON/OFF during operation on mains 230V, page No.181)
- Special layered diffuser for perfect smooth pictogram illumination
- Addressable CENTRALTEST communication module (for ATXL, ATXP only)
- LEDs indicating presence of power supply and signaling failures + TEST button
- **vysoko účinné LED (150lm/W, 5000K) so životnosťou min.100000h**
- **2 výkonné LED 120lm/W pre osvetlenie únikovej cesty na podlahe** (len pri všetkých "+2xLED" verziách)
- **progresívna elektronická jednotka**
- **LONGLIFE NiMh alebo LiFePo4 batéria**
- **Inštalčný mód** (ochrana batérie, pozri aj str.181+218)
- **Inteligentné nabíjanie batérie** ("intermittent" nabíjanie, pozri aj str.181+218)
- **DIP prepínač** umožňujúci prednastavenie funkcií:
  - **ECO Mód** (stmievanie 10%-100%, pozri aj str.181+218)
  - **ENERGY Saving Mód** (osvetlenie pikto na 2cd/m<sup>2</sup> alebo 200cd/m<sup>2</sup>, pozri aj str.181)
  - ovládanie **2 spodných LED** (zap/vyp počas normálneho režimu 230V)
- špeciálne vrstvené plexi pre perfektné rovnomerné osvetlenie piktogramu
- adresovateľný CENTRALTEST komunikačný modul (len pre ATXL, ATXP verzie)
- signalizácia LED a TEST tlačítko



Accessory: Diffuser in AL Frame+Legend  
Príplatkový kryt svietidla v AL ráme+pikto  
(look up also page No.220)

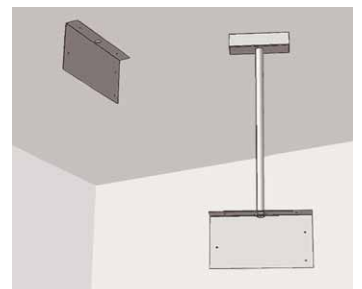

Optional Brackets  
Príplatkové konzoly  
(look up also page No.220)

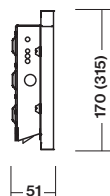
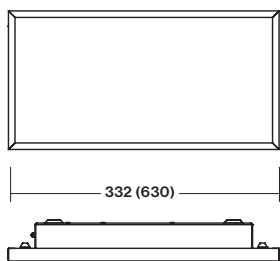

\* Dimensions in the bracket are valid for all "B" versions  
\* rozmery v zátvorke platia pre všetky "B" verzie

Premium Line  
Slim Surface Mounted Emergency Luminaire

## C.PRIMALUX-LED / MULTIPRIMA-LED

Page No.162

### AUTOTEST -AT NM/M

Type	Version	Duration	Light Source	Light Flux/Emerg.mode	Battery	Order Code	Weight
MULTIPRIMA-A-AT.1h	NM/M	1h	18xMidPower LEDs	N.A.	NiMh 4,8V/1,1Ah	295-B-001-01-00-00	1,6 kg
MULTIPRIMA-A-AT.1h	NM/M	1h	18xMidPower LEDs	N.A.	LiFePo4 6,4V/1,0Ah	295-B-001-04-00-00	1,6 kg
MULTIPRIMA-A-AT.3h	NM/M	3h	18xMidPower LEDs	N.A.	NiMh 4,8V/3,0Ah	295-B-002-02-00-00	1,7 kg
MULTIPRIMA-A-AT+2xLED.1h	NM/M	1h	18x LEDs + 2x LEDs	- / 100 lm	NiMh 4,8V/1,1Ah	295-B-003-01-00-00	1,7 kg
MULTIPRIMA-A-AT+2xLED.1h	NM/M	1h	18x LEDs + 2x LEDs	- / 100 lm	LiFePo4 6,4V/1,0Ah	295-B-003-04-00-00	1,7 kg
MULTIPRIMA-A-AT+2xLED.3h	NM/M	3h	18x LEDs + 2x LEDs	- / 100 lm	NiMh 4,8V/3,0Ah	295-B-004-02-00-00	1,7 kg
MULTIPRIMA-B-AT.1h	NM/M	1h	36xMidPower LEDs	N.A.	NiMh 4,8V/1,1Ah	295-B-005-01-00-00	3,5 kg
MULTIPRIMA-B-AT.3h	NM/M	3h	36xMidPower LEDs	N.A.	NiMh 4,8V/3,0Ah	295-B-006-02-00-00	3,5 kg

### DALI

Type	Version	Duration	Light Source	Light Flux / Emergency mode	Battery	Order Code	Weight
MULTIPRIMA-A-DALI.3h	NM/M	3h	18xMidPower LEDs	N.A.	NiMh 4,8V/2,1Ah	295-B-028-02-00-00	1,6 kg

Page No.166

### CENTRALTEST -ATXL ELMAX-LOOK

Type	Version	Duration	Light Source	Light Flux/Emerg.mode	Battery	Order Code	Weight
MULTIPRIMA-A-ATXL.1h	NM/M	1h	18xMidPower LEDs	N.A.	NiMh 4,8V/1,1Ah	295-B-007-01-00-00	1,7 kg
MULTIPRIMA-A-ATXL.1h	NM/M	1h	18xMidPower LEDs	N.A.	LiFePo4 6,4V/1,0Ah	295-B-007-04-00-00	1,7 kg
MULTIPRIMA-A-ATXL.3h	NM/M	3h	18xMidPower LEDs	N.A.	NiMh 4,8V/3,0Ah	295-B-008-02-00-00	1,8 kg
MULTIPRIMA-A-ATXL+2xLED.1h	NM/M	1h	18x LEDs + 2x LEDs	- / 100 lm	NiMh 4,8V/1,1Ah	295-B-009-01-00-00	1,8 kg
MULTIPRIMA-A-ATXL+2xLED.1h	NM/M	1h	18x LEDs + 2x LEDs	- / 100 lm	LiFePo4 6,4V/1,0Ah	295-B-009-04-00-00	1,8 kg
MULTIPRIMA-A-ATXL+2xLED.3h	NM/M	3h	18x LEDs + 2x LEDs	- / 100 lm	NiMh 4,8V/3,0Ah	295-B-010-02-00-00	1,8 kg
MULTIPRIMA-B-ATXL.1h	NM/M	1h	36xMidPower LEDs	N.A.	NiMh 4,8V/1,1Ah	295-B-011-01-00-00	3,6 kg
MULTIPRIMA-B-ATXL.3h	NM/M	3h	36xMidPower LEDs	N.A.	NiMh 4,8V/3,0Ah	295-B-012-02-00-00	3,6 kg

Page No.168

### Wireless CENTRALTEST ELMAX-ATZB

Type	Version	Duration	Light Source	Light Flux / Emergency mode	Battery	Order Code	Weight
MULTIPRIMA-A-ATZB.1h	NM/M	1h	18xMidPower LEDs	N.A.	NiMh 4,8V/1,1Ah	295-B-013-01-00-00	1,7 kg
MULTIPRIMA-A-ATZB.3h	NM/M	3h	18xMidPower LEDs	N.A.	NiMh 4,8V/3,0Ah	295-B-014-02-00-00	1,8 kg
MULTIPRIMA-A-ATZB+2xLED.1h	NM/M	1h	18x LED + 2x LED	- / 100 lm	NiMh 4,8V/1,1Ah	295-B-015-01-00-00	1,8 kg
MULTIPRIMA-A-ATZB+2xLED.3h	NM/M	3h	18x LED + 2x LED	- / 100 lm	NiMh 4,8V/3,0Ah	295-B-016-02-00-00	1,8 kg
MULTIPRIMA-B-ATZB.1h	NM/M	1h	36xMidPower LEDs	N.A.	NiMh 4,8V/1,1Ah	295-B-017-01-00-00	3,6 kg
MULTIPRIMA-B-ATZB.3h	NM/M	3h	36xMidPower LEDs	N.A.	NiMh 4,8V/3,0Ah	295-B-018-02-00-00	3,6 kg

Page No.174

### CENTRAL BATTERY (CBS)

Type	Version	Light Source	Light Flux	Order Code	Weight
C.PRIMALUX-A 230V AC/DC	CBS NON-ADDRESSABLE	18xMidPower LEDs	N.A.	295-B-019-00-00-00	1,3 kg
C.PRIMALUX-A 24V AC/DC	CBS NON-ADDRESSABLE	18xMidPower LEDs	N.A.	295-B-020-00-00-00	1,3 kg
C.PRIMALUX-A+2xLED 230V AC/DC	CBS NON-ADDRESSABLE	18x LEDs + 2x LEDs	100 lm	295-B-021-00-00-00	1,4 kg
C.PRIMALUX-A+2xLED 24V AC/DC	CBS NON-ADDRESSABLE	18x LEDs + 2x LEDs	100 lm	295-B-022-00-00-00	1,4 kg
C.PRIMALUX-B 230V AC/DC	CBS NON-ADDRESSABLE	36xMidPower LEDs	N.A.	295-B-023-00-00-00	3,1 kg
C.PRIMALUX-B 24V AC/DC	CBS NON-ADDRESSABLE	36xMidPower LEDs	N.A.	295-B-024-00-00-00	3,1 kg

Page No.170

### Addressable CENTRAL BATTERY (CBS) -ATXP ELMAX-PATROLUX

Type	Version	Light Source	Light Flux	Order Code	Weight
C.PRIMALUX-A-ATXPR 230V AC/DC	ATXP CBS ADDRESSABLE	18xMidPower LEDs	N.A.	295-B-025-00-00-00	1,4 kg
C.PRIMALUX-A-ATXPR+2xLED 230V AC/DC	ATXP CBS ADDRESSABLE	18x LED + 2x LED	100 lm	295-B-026-00-00-00	1,5 kg
C.PRIMALUX-B-ATXPR 230V AC/DC	ATXP CBS ADDRESSABLE	36xMidPower LEDs	N.A.	295-B-027-00-00-00	3,2 kg

Look up pages No. 328-335 for 1lx Spacing tables  
Pozri str. 328-335 pre rozmiestnenie svetidiel na dosiahnutie 1lx





## C.PRIMALUX-LED / MULTIPRIMA-LED

### DIP SWITCH FEATURES No.1-4 / DIP PREPÍNAČ č.1-4 - FUNKCIE

#### SELF-CONTAINED BATTERY VERSIONS

#### CBS CENTRAL BATTERY VERSIONS

##### NORMAL MODE 230V MAINS

##### EMERGENCY BATTERY MODE



**DEFFAULT SETT./ PREDNASTAVENÉ**  
Full Power for ESCAPE SIGN Applicaton  
BRIGHTNESS > 200cd/m<sup>2</sup>



**ECO MODE 50% (in 230V mode)**  
EMERGENCY MODE LEGEND  
BRIGHTNESS > 200cd/m<sup>2</sup>



**ECO MODE 25% (in 230V mode)**  
EMERGENCY MODE LEGEND  
BRIGHTNESS > 200cd/m<sup>2</sup>



**ECO MODE 10% (in 230V mode)**  
EMERGENCY MODE LEGEND  
BRIGHTNESS > 200cd/m<sup>2</sup>



**ENERGY SAVING (in emerg.mode)**  
LEGEND BRIGHTNESS > 2cd/m<sup>2</sup>  
JAS PIKTOGRAMU > 2cd/m<sup>2</sup>



**ENERGY SAVING (in emerg.mode)**  
**ECO MODE 50% (in 230V mode)**  
LEGEND BRIGHTNESS > 2cd/m<sup>2</sup>



**ENERGY SAVING (in emerg.mode)**  
**ECO MODE 25% (in 230V mode)**  
LEGEND BRIGHTNESS > 2cd/m<sup>2</sup>



**ENERGY SAVING (in emerg.mode)**  
**ECO MODE 10% (in 230V mode)**  
LEGEND BRIGHTNESS > 2cd/m<sup>2</sup>



**INSTALLATION  
MODE  
SET UP**

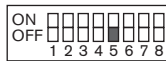

**DEFFAULT / PREDNASTAVENÉ**  
**OFF - ACTIVATED**  
ON - DEACTIVATED



**NON-MAINTAINED /  
MAINTAINED  
MODE  
SET UP**



**DEFFAULT / PREDNASTAVENÉ**  
**ON - MAINTAINED**  
OFF - NON-MAINTAINED



**AUTOTEST /  
CENTRALTEST  
MODE  
SET UP**

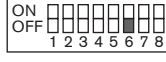

**DEFFAULT / PREDNASTAVENÉ**  
**OFF - AUTOTEST**  
ON - CENTRALTEST

##### CBS CENTRAL BATTERY



**FULL POWER**  
LEGEND BRIGHTNESS > 200cd/m<sup>2</sup>  
JAS PIKTOGRAMU > 200cd/m<sup>2</sup>



**ECO MODE 50%**



**ECO MODE 25%**



**ECO MODE 10%**  
LEGEND BRIGHTNESS > 2cd/m<sup>2</sup>  
JAS PIKTOGRAMU > 2cd/m<sup>2</sup>



**L1' FUNCT.  
LOGIC  
SET UP**



**ONLY FOR CBS VERSIONS**  
ON - NEGATIVE  
OFF - POSITIVE

**TO SEE THE CHANGE EITHER PUSH THE TEST BUTTON OR  
DISCONNECT THE FIXTURE FROM BOTH THE MAINS 230V AND BATTERY**

Po prestavení stlačte TEST alebo odpojte batériu a pripojenie na sieť na aktiváciu zmeny

## C.PRIMALUX+2xLED / MULTIPRIMA+2xLED

### DIP SWITCH FEATURES No.1-4 / DIP PREPÍNAČ č.1-4 - FUNKCIE

#### SELF-CONTAINED BATTERY VERSIONS

#### CBS CENTRAL BATTERY VERSIONS

##### NORMAL MODE 230V MAINS

##### EMERGENCY BATTERY MODE



**NO LEGEND / BEZ PIKTOGRAMU**  
ESCAPE ROUTE ILLUMINATION



**DEFFAULT SETT./ PREDNASTAVENÉ**  
Full Power for ESCAPE SIGN Applicaton  
BRIGHTNESS > 200cd/m<sup>2</sup>



**ECO MODE 50% (in 230V mode)**  
EMERGENCY MODE LEGEND  
BRIGHTNESS > 200cd/m<sup>2</sup>



**ECO MODE 25% (in 230V mode)**  
EMERGENCY MODE LEGEND  
BRIGHTNESS > 200cd/m<sup>2</sup>



**ECO MODE 10% (in 230V mode)**  
EMERGENCY MODE LEGEND  
BRIGHTNESS > 200cd/m<sup>2</sup>



**ENERGY SAVING (in emerg.mode)**  
LEGEND BRIGHTNESS > 2cd/m<sup>2</sup>  
JAS PIKTOGRAMU > 2cd/m<sup>2</sup>



**ENERGY SAVING (in emerg.mode)**  
**ECO MODE 50% (in 230V mode)**  
LEGEND BRIGHTNESS > 2cd/m<sup>2</sup>



**ENERGY SAVING (in emerg.mode)**  
**ECO MODE 25% (in 230V mode)**  
LEGEND BRIGHTNESS > 2cd/m<sup>2</sup>



**ENERGY SAVING (in emerg.mode)**  
**ECO MODE 10% (in 230V mode)**  
LEGEND BRIGHTNESS > 2cd/m<sup>2</sup>



**INSTALLATION  
MODE  
SET UP**



**DEFFAULT / PREDNASTAVENÉ**  
**OFF - ACTIVATED**  
ON - DEACTIVATED



**NON-MAINTAINED /  
MAINTAINED  
MODE  
SET UP**



**DEFFAULT / PREDNASTAVENÉ**  
**ON - MAINTAINED**  
OFF - NON-MAINTAINED



**AUTOTEST /  
CENTRALTEST  
MODE  
SET UP**



**DEFFAULT / PREDNASTAVENÉ**  
**OFF - AUTOTEST**  
ON - CENTRALTEST

##### CBS CENTRAL BATTERY



**FULL POWER**  
LEGEND BRIGHTNESS > 200cd/m<sup>2</sup>  
JAS PIKTOGRAMU > 200cd/m<sup>2</sup>



**ECO MODE 50%**



**ECO MODE 25%**



**ECO MODE 10%**  
LEGEND BRIGHTNESS > 2cd/m<sup>2</sup>  
JAS PIKTOGRAMU > 2cd/m<sup>2</sup>



**INPUT L1'  
FUNCT.  
SET UP**



**ONLY FOR CBS VERSIONS**  
ON - +2 BOTTOM LEDs CONTROL  
OFF - DIMMING



**L1' FUNCT.  
LOGIC  
SET UP**



**ONLY FOR CBS VERSIONS**  
ON - NEGATIVE  
OFF - POSITIVE

**TO SEE THE CHANGE EITHER PUSH THE TEST BUTTON OR  
DISCONNECT THE FIXTURE FROM BOTH THE MAINS 230V AND BATTERY**

Po prestavení stlačte TEST alebo odpojte batériu a pripojenie na sieť na aktiváciu zmeny

## C.PRIMALUX-LED / MULTIPRIMA-LED

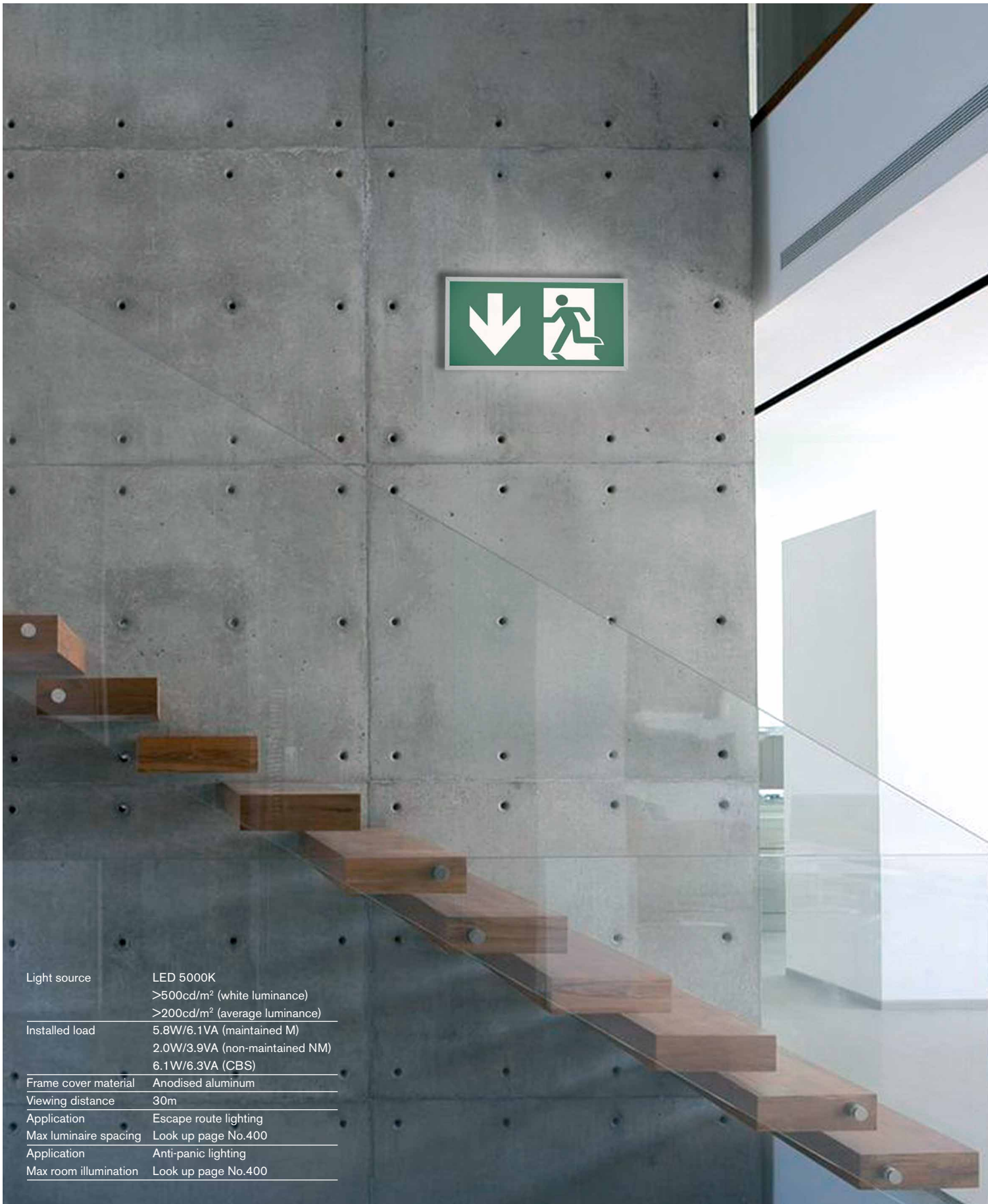

Light source	LED 5000K >500cd/m <sup>2</sup> (white luminance) >200cd/m <sup>2</sup> (average luminance)
Installed load	5.8W/6.1VA (maintained M) 2.0W/3.9VA (non-maintained NM) 6.1W/6.3VA (CBS)
Frame cover material	Anodised aluminum
Viewing distance	30m
Application	Escape route lighting
Max luminaire spacing	Look up page No.400
Application	Anti-panic lighting
Max room illumination	Look up page No.400

## C.PRIMALUX-LED / MULTIPRIMA-LED

Available in black RAL9005 colour  
Order code on demand  
Dostupné aj čiernej farbe RAL9005  
obj.kód ba požiadanie



- Diffuser in AL frame including legend in accordance with ISO7010
- **It is not included in standard package. It must be ordered as separate item !**
- Viewing Distance 30m: (for all "A" size versions), 60m (for all "B" size versions)
- Legend luminance >500cd/m<sup>2</sup> (white)
- kryt svietidla v AL ráme s piktogramom v súlade s ISO7010
- **nie je súčasťou štandardného balenia svietidla, musí byť objednané ako samostatná položka !**
- rozoznatelnosť piktogramu: 30m (pre veľkosť A), 60m (pre veľkosť B)
- jas piktogramu >500cd/m<sup>2</sup> (biela)

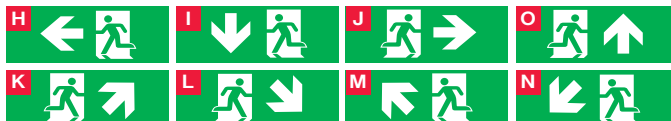

All "A" Size versions / pre všetky verzie veľkosť "A"	Order Code / Objednávaci kód
Diffuser with legend "H" / kryt s pikto typ "H"	295-B-000-01-00-00
Diffuser with legend "I" / kryt s pikto typ "I"	295-B-000-02-00-00
Diffuser with legend "J" / kryt s pikto typ "J"	295-B-000-03-00-00
Diffuser with legend "K" / kryt s pikto typ "K"	295-B-000-04-00-00
Diffuser with legend "L" / kryt s pikto typ "L"	295-B-000-05-00-00
Diffuser with legend "M" / kryt s pikto typ "M"	295-B-000-06-00-00
Diffuser with legend "N" / kryt s pikto typ "N"	295-B-000-07-00-00
Diffuser with legend "O" / kryt s pikto typ "O"	295-B-000-08-00-00

All "B" Size versions / pre všetky verzie veľkosť "B"	Order Code / Objednávaci kód
Diffuser with legend "H" / kryt s pikto typ "H"	295-B-000-10-00-00
Diffuser with legend "I" / kryt s pikto typ "I"	295-B-000-11-00-00
Diffuser with legend "J" / kryt s pikto typ "J"	295-B-000-12-00-00
Diffuser with legend "K" / kryt s pikto typ "K"	295-B-000-13-00-00
Diffuser with legend "L" / kryt s pikto typ "L"	295-B-000-14-00-00
Diffuser with legend "M" / kryt s pikto typ "M"	295-B-000-15-00-00
Diffuser with legend "N" / kryt s pikto typ "N"	295-B-000-16-00-00
Diffuser with legend "O" / kryt s pikto typ "O"	295-B-000-20-00-00

### Additional Bottom HighPower LEDs (valid only for all "+2xLED" versions)

- for escape route illumination on the floor
- for 1x Spacing Tables Look up Page No.328-335
- Prídavné 2x HighPower LED na spodnej strane svietidla (len pre verzie "+2xLED")
- pre nasvietenie únikovej cesty na podlahe
- tabuľky rozmiestnenia svietidiel pre 1x hladinu osvetlenia pozri str. 328-335

### Options: / Příplatky:

- Wall / Ceiling / Pendant mounting bracket
- Protective Steel Cage
- nástenná / stropná / závesná konzola
- ochranný kôš

Optional Item / Příplatek	Order Code / objednávací kód
Wall mounting bracket "A" / nástenná konzola "A"	295-B-200-01
Wall mounting bracket "B" / nástenná konzola "B"	295-B-200-02
Ceiling mounting bracket "A" / stropná konzola "A"	295-B-201-01
Ceiling mounting bracket "B" / stropná konz. "B"	295-B-201-02
Pendant bracket 0,5m "A" / záves. konz. 0,5m "A"	295-B-202-01
Pendant bracket 0,5m "B" / záves. konz. 0,5m "B"	295-B-202-02
Pendant bracket 1,0m "A" / záves. konz. 1,0m "A"	295-B-203-01
Pendant bracket 1,0m "B" / záves. konz. 1,0m "B"	295-B-203-02
Pendant bracket 1,5m "A" / záves. konz. 1,5m "A"	295-B-204-01
Pendant bracket 1,5m "B" / záves. konz. 1,5m "B"	295-B-204-02
Protective stell cage "A" / ochranný kôš "A"	295-B-205-01
Protective stell cage "B" / ochranný kôš "B"	295-B-205-02



## C.PRIMALUX-LED / MULTIPRIMA-LED



Light source	LED 5000K >500cd/m <sup>2</sup> (white luminance) >200cd/m <sup>2</sup> (average luminance)
Installed load	5.8W/6.1VA (maintained M) 2.0W/3.9VA (non-maintained NM) 6.1W/6.3VA (CBS)
Frame cover material	Anodised aluminum
Viewing distance	30m
Application	Escape route lighting
Max luminaire spacing	Look up page No.400
Application	Anti-panic lighting
Max room illumination	Look up page No.400



## C.PRIMALUX-AP-LED / MULTIPRIMA-AP-LED

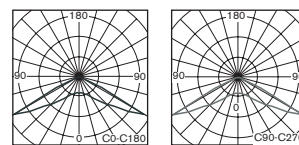
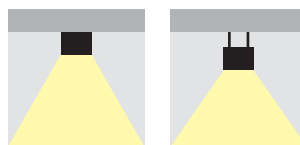
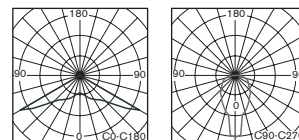

← → 30m

MULTIPRIMA-AP



← → 30m

MULTIPRIMA-APB+2xLED

- Exclusive slim design doublesided ceiling mounted fixture for non-maintained/ maintained (NM/M) or centralised (C) emergency lighting available in all following versions:
  - **AUTOTEST** (-AT) or **DALI**
  - **CENTRALTEST** (-ATXL) for ELMAX LOOK system (look up also page No.166)
  - **Wireless CENTRALTEST** (-ATZB) for ELMAX-ATZB system (page No.168)
  - **CENTRAL BATTERY** (C.PRIMALUX) for **non-addressable CBS** (look up also page No.174)
  - **CENTRAL BATTERY** (-ATXP) for system **ELMAX-PATROLUX & Addressable CBS** (look up also page No.170)
- Conforming to the requirement of EN60598-2-22, EN1838, EN62034
- Design:
  - Anodised AL profile base
  - Acrylic layered diffuser with legend in anodised AL frame
- "štíhle" elegantné obojstranné stropné núdzové svietidlo pre netrvalé/trvalé (NM/M) alebo (C) centrálné napájané núdzové osvetlenie dostupné vo verziách:
  - **AUTOTEST** (-AT) alebo DALI
  - **CENTRALTEST** (-ATXL) pre systém ELMAX LOOK (pozri str.166)
  - **bezdrôtový CENTRALTEST** (-ATZB) pre ELMAX-ATZB systém (str.168)
  - **CENTRAL BATTERY** (C.PRIMALUX) pre **neadresovateľné CBS** (str.174)
  - **CENTRAL BATTERY** (-ATXP) pre systém **ELMAX-PATROLUX s adresovateľnou CBS** (pozri str. 170)
- spĺňa požiadavky európskej normy EN 60598-2-22, EN1838, EN62034
- konštrukcia:
  - základňa z eloxovaného hliníkového profilu
  - svetelno-činný kryt z vrstveného plexi v ráme z eloxovaného hliníku

### STANDARD FEATURES

### STANDARDNÁ VÝBAVA

- **High efficient (150lm/W, 5000K) LONGLIFE LEDs (>100.000h)**
- **2pcs of High-Power bottom LEDs** 120lm/W for floor escape root illumination (valid only for all "+2xLED" versions)
- **NEW Advanced Electronics**
- **LONGLIFE NiMh or LiFePo4 battery**
- **Installation Mode** (battery protection, for more details look up page No.181+218)
- **Intelligent battery charging** (intermittent charging, look up page No.181+218)
- **DIP Switch** allowing to preset following functions:
  - **ECO Mode** (dimming 10%-100%, for more details look up page No.181+218)
  - **ENERGY Saving Mode** (picto illumination 2cd/m<sup>2</sup> or 200cd/m<sup>2</sup>, look up page 181)
  - **2 bottom LEDs control** (ON/OFF during operation on mains 230V, page No.181)
- Special layered diffuser for perfect smooth pictogram illumination
- Addressable CENTRALTEST communication module (for ATXL, ATXP only)
- LEDs indicating presence of power supply and signaling failures + TEST button
- **vysoko účinné LED (150lm/W, 5000K) so životnosťou min.100000h**
- **2 výkonné LED 120lm/W pre osvetlenie únikovej cesty na podlahe** (len pri všetkých "+2xLED" verziách)
- **progresívna elektronická jednotka**
- **LONGLIFE NiMh alebo LiFePo4 batéria**
- **Inštalčný mód** (ochrana batérie, pozri aj str.181+218)
- **Inteligentné nabíjanie batérie** ("intermittent" nabíjanie, pozri aj str.181+218)
- **DIP prepínač** umožňujúci prednastavenie funkcií:
  - **ECO Mód** (stmievanie 10%-100%, pozri aj str.181+218)
  - **ENERGY Saving Mód** (osvetlenie piko na 2cd/m<sup>2</sup> alebo 200cd/m<sup>2</sup>, pozri aj str.181)
- ovládanie **2 spodných LED** (zap/vyp počas normálneho režimu 230V)
- špeciálne vrstvené plexi pre perfektné rovnomerné osvetlenie piktogramu
- adresovateľný CENTRALTEST komunikačný modul (len pre ATXL, ATXP verzie)
- signalizácia LED a TEST tlačítko



#### Input Power:

- 5,8W/ 6,1VA (maintained M)
- 2,0W/ 3,9VA (non-maintained NM)
- 6,1W/ 6,3VA (CBS)

Available in black RAL9005 colour

Order code on demand

Dostupné aj čiernej farbe RAL9005

obj.kód ba požiadanie



Optional end cap with cable entry holes  
Príplatkové bočné čeličko s prechodkami  
(look up also page No.224)



Accessory: Diffuser in AL Frame+Legend  
Príplatkový kryt svietidla v AL ráme+pikto  
(look up also page No.224)

# C.PRIMALUX-AP-LED / MULTIPRIMA-AP-LED

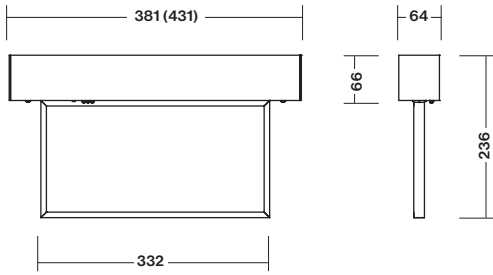

\* Dimensions in the bracket are valid for all "APA, APB" versions  
\* rozmery v zátvorke platia pre všetky "APA, APB" verzie

### Escape route illumination by 2 additional HighPower LEDs

- version APA for corridor application Escape Route illumination
- version APB for open area application Anti Panic Lighting

### Anti-panik osvetlenie prídavnými 2xHighPower LED

- verzia APA pre aplikáciu pre koridor / Escape Route
- verzia APB pre aplikáciu v otvorenom priestore "anti-panik"

#### 1LX SPACING TABLE / ROZMIESTNENIE PRE 1LX

H (m)	Y1 (m)	Y2 (m)
2,75	6,6	17,5
3,00	6,1	17,9
3,50	5,7	18,0
4,00	4,7	17,5
4,50	3,5	17,1

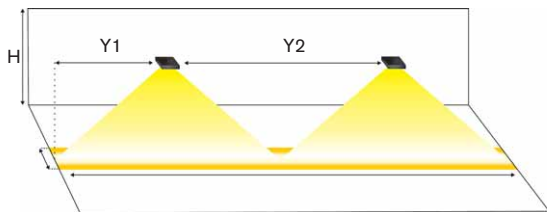

#### 1LX SPACING TABLE / ROZMIESTNENIE PRE 1LX

H (m)	X1 (m)	X2 (m)	Y1 (m)	Y2 (m)
2,75	4,0	10,5	3,0	9,6
3,00	3,1	11,3	2,3	9,8

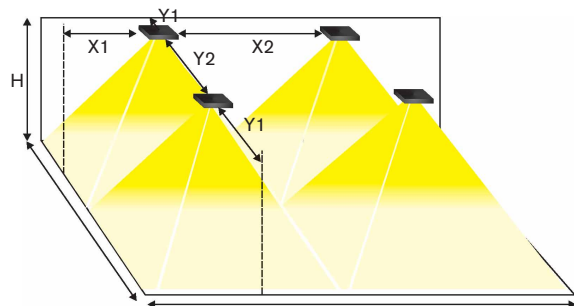

- Optional Wire rope suspension set (for the Item No. look up page No.230)
- Priplatkový lankový závesný set (pre obj.kód pozri str. 230)

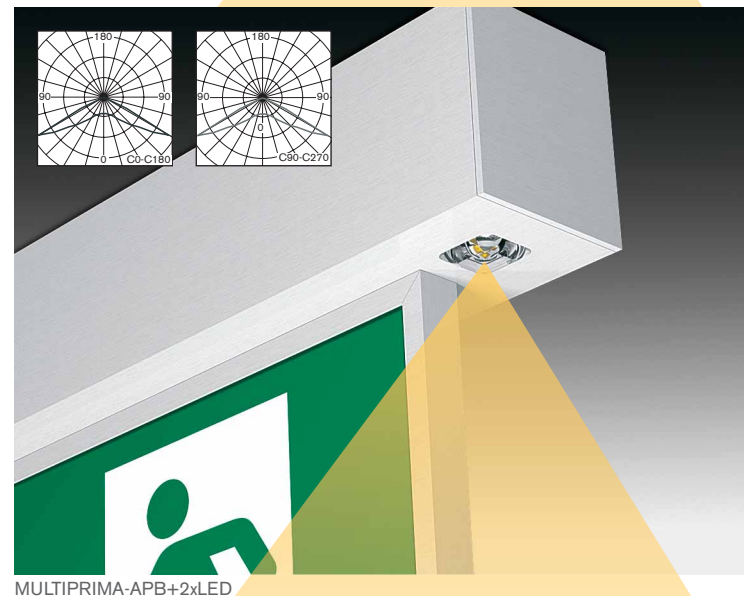



- Diffuser in AL frame including legend in accordance with ISO7010
- **It is not included in standard package. It must be ordered as separate item !**

- Viewing Distance 30m
- Legend luminance: >500cd/m<sup>2</sup> (white)

- kryt svetidla v AL ráme s piktogramom v súlade s ISO7010
- **nie je súčasťou štandardného balenia svetidla, musí byť objednané ako samostatná položka !**
- rozoznatelnosť piktogramu 30m
- jas piktogramu: >500cd/m<sup>2</sup> (biela)

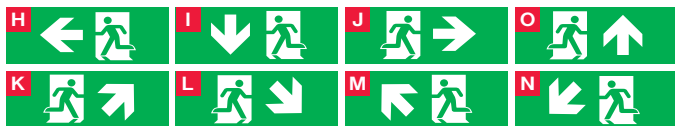

Item / Položka	Order Code / Objednávaci kód
Single sided diffuser with legend "H" Jednostranný kryt s pikto typ "H"	295-B-000-020-00-00
Single sided diffuser with legend "I" Jednostranný kryt s pikto typ "I"	295-B-000-021-00-00
Single sided diffuser with legend "J" Jednostranný kryt s pikto typ "J"	295-B-000-022-00-00
Single sided diffuser with legend "O" Jednostranný kryt s pikto typ "O"	295-B-000-023-00-00
Single sided diffuser with legend "K" Jednostranný kryt s pikto typ "K"	295-B-000-024-00-00
Single sided diffuser with legend "L" Jednostranný kryt s pikto typ "L"	295-B-000-025-00-00
Single sided diffuser with legend "M" Jednostranný kryt s pikto typ "M"	295-B-000-026-00-00
Single sided diffuser with legend "N" Jednostranný kryt s pikto typ "N"	295-B-000-027-00-00
Double sided diffuser with legend "H/J" Obojstranný kryt s pikto typ "H/J"	295-B-000-028-00-00
Double sided diffuser with legend "I" Obojstranný kryt s pikto typ "I"	295-B-000-029-00-00
Double sided diffuser with legend "O" Obojstranný kryt s pikto typ "O"	295-B-000-030-00-00
Double sided diffuser with legend "K/M" Obojstranný kryt s pikto typ "K/M"	295-B-000-031-00-00
Double sided diffuser with legend "L/N" Obojstranný kryt s pikto typ "L/N"	295-B-000-032-00-00



**Options: / Priplatky:**

- Wire rope suspension set including all:
  - 2pcs of tool-free adjustable wire holders located on the fixture body for rapid mounting and adjustment of suspension length
  - 2pcs of suspension steel wire ropes 0.8m long
  - 1pc of ceiling power outlets + 1.5m long cord
- End cap with cable entry holes

- Závesný lankový set obsahuje:
  - 2ks nastaviteľných závesov pre nastavenie požadovanej dĺžky závesu
  - 2ks závesných laniek dĺžky 0,8m
  - 1ks sieťovej prípojnej krabičky na strop + číry prívodný elektrický kábel 1,5m dlhý
- Bočné čelíčko s prechodkami pre kabeľaž zo strany

Optional Item / Priplatok	Order Code / objednávaci kód
Wire rope suspension kit 1.5 m long Závesná lanková sada dĺžky 1,5 m	295-B-206-001-00-00
End cap with cable entry holes Bočné čelíčko s prechodkami pre kabeľaž z boku	295-B-207-001-00-00



## C.PRIMALUX-AP-LED / MULTIPRIMA-AP-LED

Page No.162

### AUTOTEST -AT NM/M

Type	Version	Duration	Light Source	Light Flux/Emerg.mode	Battery	Order Code	Weight
MULTIPRIMA-AP-AT.1h	NM/M	1h	18xMidPower LEDs	N.A.	NiMh 4,8V/1,1Ah	295-B-300-01-00-00	1,6 kg
MULTIPRIMA-AP-AT.1h	NM/M	1h	18xMidPower LEDs	N.A.	LiFePo4 6,4V/1,0Ah	295-B-300-04-00-00	1,6 kg
MULTIPRIMA-AP-AT.3h	NM/M	3h	18xMidPower LEDs	N.A.	NiMh 4,8V/3,0Ah	295-B-301-02-00-00	1,7 kg
MULTIPRIMA-APA-AT+2xLED.1h	NM/M	1h	18x LEDs + 2x LEDs	- / 100 lm	NiMh 4,8V/1,1Ah	295-B-302-01-00-00	1,7 kg
MULTIPRIMA-APA-AT+2xLED.1h	NM/M	1h	18x LEDs + 2x LEDs	- / 100 lm	LiFePo4 6,4V/1,0Ah	295-B-302-04-00-00	1,7 kg
MULTIPRIMA-APA-AT+2xLED.3h	NM/M	3h	18x LEDs + 2x LEDs	- / 100 lm	NiMh 4,8V/3,0Ah	295-B-303-02-00-00	1,8 kg
MULTIPRIMA-APB-AT+2xLED.1h	NM/M	1h	18x LEDs + 2x LEDs	- / 100 lm	NiMh 4,8V/1,1Ah	295-B-304-01-00-00	1,7 kg
MULTIPRIMA-APB-AT+2xLED.1h	NM/M	1h	18x LEDs + 2x LEDs	- / 100 lm	LiFePo4 6,4V/1,0Ah	295-B-304-04-00-00	1,7 kg
MULTIPRIMA-APB-AT+2xLED.3h	NM/M	3h	18x LEDs + 2x LEDs	- / 100 lm	NiMh 4,8V/3,0Ah	295-B-305-02-00-00	1,8 kg

### DALI

Type	Version	Duration	Light Source	Light Flux / Emergency mode	Battery	Order Code	Weight
MULTIPRIMA-AP-DALI.3h	NM/M	3h	18xMidPower LEDs	N.A.	NiMh 4,8V/2,1Ah	295-B-327-02-00-00	1,6 kg

Page No.166

### CENTRALTEST -ATXL ELMAX-LOOK

Type	Version	Duration	Light Source	Light Flux/Emerg.mode	Battery	Order Code	Weight
MULTIPRIMA-AP-ATXL.1h	NM/M	1h	18xMidPower LEDs	N.A.	NiMh 4,8V/1,1Ah	295-B-306-01-00-00	1,6 kg
MULTIPRIMA-AP-ATXL.1h	NM/M	1h	18xMidPower LEDs	N.A.	LiFePo4 6,4V/1,0Ah	295-B-306-04-00-00	1,6 kg
MULTIPRIMA-AP-ATXL.3h	NM/M	3h	18xMidPower LEDs	N.A.	NiMh 4,8V/3,0Ah	295-B-307-02-00-00	1,7 kg
MULTIPRIMA-APA-ATXL+2xLED.1h	NM/M	1h	18x LEDs + 2x LEDs	- / 100 lm	NiMh 4,8V/1,1Ah	295-B-308-01-00-00	1,7 kg
MULTIPRIMA-APA-ATXL+2xLED.1h	NM/M	1h	18x LEDs + 2x LEDs	- / 100 lm	LiFePo4 6,4V/1,0Ah	295-B-308-04-00-00	1,7 kg
MULTIPRIMA-APA-ATXL+2xLED.3h	NM/M	3h	18x LEDs + 2x LEDs	- / 100 lm	NiMh 4,8V/3,0Ah	295-B-309-02-00-00	1,8 kg
MULTIPRIMA-APB-ATXL+2xLED.1h	NM/M	1h	18x LEDs + 2x LEDs	- / 100 lm	NiMh 4,8V/1,1Ah	295-B-310-01-00-00	1,7 kg
MULTIPRIMA-APB-ATXL+2xLED.1h	NM/M	1h	18x LEDs + 2x LEDs	- / 100 lm	LiFePo4 6,4V/1,0Ah	295-B-310-04-00-00	1,7 kg
MULTIPRIMA-APB-ATXL+2xLED.3h	NM/M	3h	18x LEDs + 2x LEDs	- / 100 lm	NiMh 4,8V/3,0Ah	295-B-311-02-00-00	1,8 kg

Page No.168

### Wireless CENTRALTEST ELMAX-ATZB

Type	Version	Duration	Light Source	Light / Emergency mode	Battery	Order Code	Weight
MULTIPRIMA-AP-ATZB.1h	NM/M	1h	18xMidPower LEDs	N.A.	NiMh 4,8V/1,1Ah	295-B-312-01-00-00	1,6 kg
MULTIPRIMA-AP-ATZB.3h	NM/M	3h	18xMidPower LEDs	N.A.	NiMh 4,8V/3,0Ah	295-B-313-02-00-00	1,7 kg
MULTIPRIMA-APA-ATZB+2xLED.1h	NM/M	1h	18x LEDs + 2x LEDs	- / 100 lm	NiMh 4,8V/1,1Ah	295-B-314-01-00-00	1,7 kg
MULTIPRIMA-APA-ATZB+2xLED.3h	NM/M	3h	18x LEDs + 2x LEDs	- / 100 lm	NiMh 4,8V/3,0Ah	295-B-315-02-00-00	1,8 kg
MULTIPRIMA-APB-ATZB+2xLED.1h	NM/M	1h	18x LEDs + 2x LEDs	- / 100 lm	NiMh 4,8V/1,1Ah	295-B-316-01-00-00	1,7 kg
MULTIPRIMA-APB-ATZB+2xLED.3h	NM/M	3h	18x LEDs + 2x LEDs	- / 100 lm	NiMh 4,8V/3,0Ah	295-B-317-02-00-00	1,8 kg

Page No.174

### CENTRAL BATTERY (CBS)

Type	Version	Light Source	Light Flux	Order Code	Weight
C.PRIMALUX-AP 230V AC/DC	CBS NON-ADDRESSABLE	18xMidPower LEDs	N.A.	295-B-318-00-00-00	1,3 kg
C.PRIMALUX-AP 24V AC/DC	CBS NON-ADDRESSABLE	18xMidPower LEDs	N.A.	295-B-319-00-00-00	1,3 kg
C.PRIMALUX-APA+2xLED 230V AC/DC	CBS NON-ADDRESSABLE	18x LEDs + 2x LEDs	100 lm	295-B-320-00-00-00	1,4 kg
C.PRIMALUX-APA+2xLED 24V AC/DC	CBS NON-ADDRESSABLE	18x LEDs + 2x LEDs	100 lm	295-B-321-00-00-00	1,4 kg
C.PRIMALUX-APB+2xLED 230V AC/DC	CBS NON-ADDRESSABLE	18x LEDs + 2x LEDs	100 lm	295-B-322-00-00-00	1,4 kg
C.PRIMALUX-APB+2xLED 24V AC/DC	CBS NON-ADDRESSABLE	18x LEDs + 2x LEDs	100 lm	295-B-323-00-00-00	1,4 kg

Page No.170

### Addressable CENTRAL BATTERY (CBS) -ATXP ELMAX-PATROLUX

Type	Version	Light Source	Light Flux	Order Code	Weight
C.PRIMALUX-AP-ATXPR 230V AC/DC	ATXP CBS ADDRESSABLE	18xMidPower LEDs	N.A.	295-B-324-00-00-00	1,4 kg
C.PRIMALUX-APA-ATXPR+2xLED 230V AC/DC	ATXP CBS ADDRESSABLE	18x LED + 2x LED	100 lm	295-B-325-00-00-00	1,5 kg
C.PRIMALUX-APB-ATXPR+2xLED 230V AC/DC	ATXP CBS ADDRESSABLE	18x LED + 2x LED	100 lm	295-B-326-00-00-00	1,5 kg

Look up pages No. 328-335 for 1lx Spacing tables  
Pozri str. 328-335 pre rozmiestnenie svietidiel na dosiahnutie 1lx



Light source	LED 5000K >500cd/m <sup>2</sup> (white luminance) >200cd/m <sup>2</sup> (average luminance)
Installed load	5.8W/6.1VA (maintained M) 2.0W/3.9VA (non-maintained NM) 6.1W/6.3VA (CBS)
Frame cover material	Anodised aluminum
Viewing distance	30m
Application	Escape route lighting
Max luminaire spacing	up to <b>18m &gt; 1lx</b>
Application	Anti-panic lighting
Max room illumination	up to <b>86m<sup>2</sup> &gt; 0.5lx</b>



Light source	LED 5000K >500cd/m <sup>2</sup> (white luminance) >200cd/m <sup>2</sup> (average luminance)
Installed load	5.8W/6.1VA (maintained M) 2.0W/3.9VA (non-maintained NM) 6.1W/6.3VA (CBS)
Frame cover material	Anodised aluminum
Viewing distance	30m
Application	Escape route lighting
Max luminaire spacing	up to <b>18m &gt; 1lx</b>
Application	Anti-panic lighting
Max room illumination	up to <b>86m<sup>2</sup> &gt; 0.5lx</b>

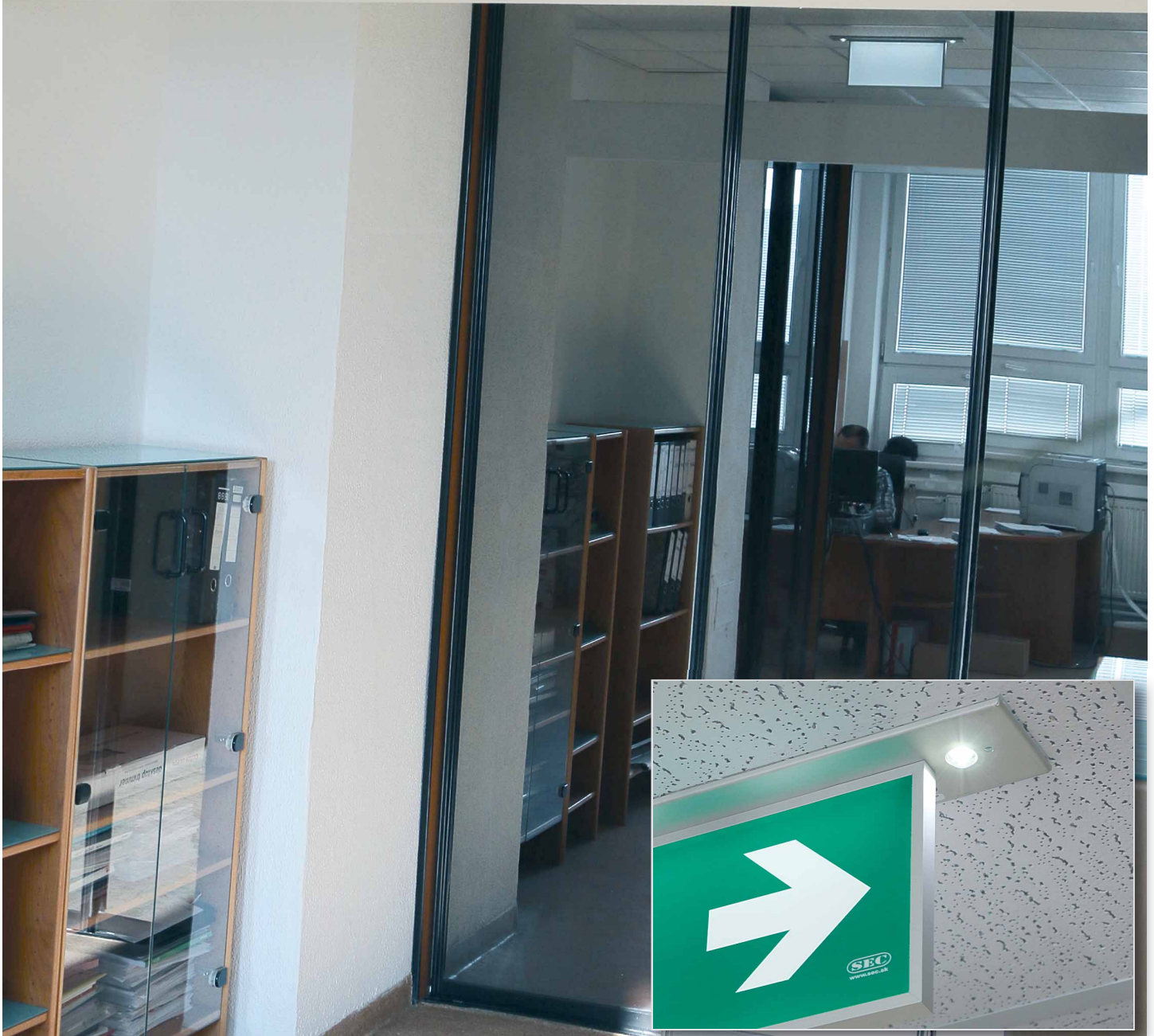



## C.PRIMALUX-AV-LED / MULTIPRIMA-AV-LED

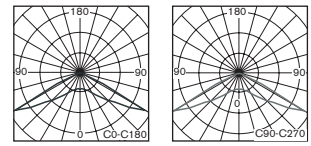
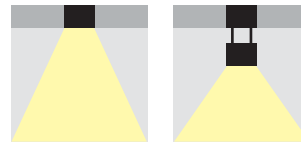
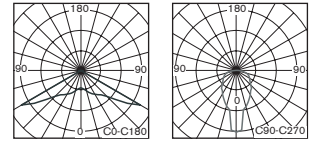

← → 30m

MULTIPRIMA-AV



← → 30m

MULTIPRIMA-AVB+2xLED

- Exclusive slim design doublesided recessed mounted fixture for non-maintained/ maintained (NM/M) or centralised (C) emergency lighting available in all following versions:

- **AUTOTEST** (-AT) or **DALI**
- **CENTRALTEST** (-ATXL) for ELMAX LOOK system (look up also page No.166)
- **Wireless CENTRALTEST** (-ATZB) for ELMAX-ATZB system (page No.168)
- **CENTRAL BATTERY** (C.PRIMALUX) for **non-addressable CBS** (look up also page No.174)
- **CENTRAL BATTERY** (-ATXP) for system **ELMAX-PATROLUX & Addressable CBS** (look up also page No.170)

- Conforming to the requirement of EN60598-2-22, EN1838, EN62034

• Design:

- Anodised AL profile base
- Acrylic layered diffuser with legend in anodised AL frame

- "štíhle" elegantné obojstranné stropné zapustené núdzové svetidlo pre netrvalé/trvalé (NM/M) alebo (C) centrálné napájané núdzové osvetlenie dostupné vo verziách:

- **AUTOTEST** (-AT) alebo **DALI**
- **CENTRALTEST** (-ATXL) pre systém ELMAX LOOK (pozri str.166)
- **bezdrôtový CENTRALTEST** (-ATZB) pre ELMAX-ATZB systém (str.168)
- **CENTRAL BATTERY** (C.PRIMALUX) pre **neadresovateľné CBS** (str.174)
- **CENTRAL BATTERY** (-ATXP) pre systém **ELMAX-PATROLUX s adresovateľnou CBS** (pozri str. 170)

- spĺňa požiadavky európskej normy EN 60598-2-22, EN1838, EN62034

• konštrukcia:

- základňa z eloxovaného hliníkového profilu
- svetelno-činný kryt z vrstveného plexi v ráme z eloxovaného hliníku

### STANDARD FEATURES

### ŠTANDARDNÁ VÝBAVA

- **High efficient (150lm/W, 5000K) LONGLIFE LEDs (>100.000h)**
- **2pcs of High-Power bottom LEDs** 120lm/W for floor escape root illumination (valid only for all "+2xLED" versions)
- **NEW Advanced Electronics**
- **LONGLIFE NiMh or LiFePo4 battery**
- **Installation Mode** (battery protection, for more details look up page No.181+218)
- **Intelligent battery charging** (intermittent charging, look up page No.181+218)
- **DIP Switch** allowing to preset following functions:
  - **ECO Mode** (dimming 10%-100%, for more details look up page No.181+218)
  - **ENERGY Saving Mode** (picto illumination 2cd/m<sup>2</sup> or 200cd/m<sup>2</sup>, look up page 181)
  - **2 bottom LEDs control** (ON/OFF during operation on mains 230V, page No.181)
- Special layered diffuser for perfect smooth pictogram illumination
- Addressable CENTRALTEST communication module (for ATXL, ATXP only)
- LEDs indicating presence of power supply and signaling failures + TEST button

- **vysoko účinné LED (150lm/W, 5000K) so životnosťou min.100000h**
- **2 výkonné LED 120lm/W pre osvetlenie únikovej cesty na podlahe** (len pri všetkých "+2xLED" verziách)
- **progresívna elektronická jednotka**
- **LONGLIFE NiMh alebo LiFePo4 batéria**
- **Inštaláčny mód** (ochrana batérie, pozri aj str.181+218)
- **Inteligentné nabíjanie batérie** ("intermittent" nabíjanie, pozri aj str.181+218)
- **DIP prepínač** umožňujúci prednastavenie funkcií:
  - **ECO Mód** (stmievanie 10%-100%, pozri aj str.181+218)
  - **ENERGY Saving Mód** (osvetlenie pikto na 2cd/m<sup>2</sup> alebo 200cd/m<sup>2</sup>, pozri aj str.181)
  - ovládanie **2 spodných LED** (zap/vyp počas normálneho režimu 230V)
- špeciálne vrstvené plexi pre perfektné rovnomerné osvetlenie piktogramu
- adresovateľný CENTRALTEST komunikačný modul (len pre ATXL, ATXP verzie)
- signalizácia LED a TEST tlačítko



**Input Power:**

- 5,8W/ 6,1VA (maintained M)
- 2,0W/ 3,9VA (non-maintained NM)
- 6,1W/ 6,3VA (CBS)

Available in black RAL9005 colour

Order code on demand

Dostupné aj čiernej farbe RAL9005

obj.kód ba požiadanie



Optional Wire Rope Suspension  
Príplatkový lankový záves 2m  
(look up also page No.230)



Accessory: Diffuser in AL Frame+Legend  
Príplatkový kryt svetidla v AL ráme+pikto  
(look up also page No.230)

# C.PRIMALUX-AV-LED / MULTIPRIMA-AV-LED

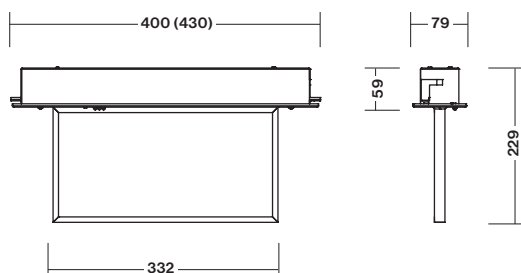

\* Dimensions in the bracket are valid for all "AVA, AVB" versions  
 \* rozmery v zátvorke platia pre všetky "AVA, AVB" verzie



Recessed mounting hole size for all -AVA/-AVB versions: **400x60 mm**  
 Rozmer montážneho otvoru pre verzie -AVA/-AVB: **400x60 mm**

Recessed mounting hole size for all -AVA/-AVB +2xLED versions: **430x60 mm**  
 Rozmer montážneho otvoru pre verzie -AVA/-AVB +2xLED: **430x60 mm**

### Escape route illumination by 2 additional HighPower LEDs

- version APA for corridor application Escape Route illumination
- version APB for open area application Anti Panic Lighting

### Anti-panik osvetlenie prídavnými 2xHighPower LED

- verzia APA pre aplikáciu pre koridor / Escape Route
- verzia APB pre aplikáciu v otvorenom priestore "anti-panik"

#### 1LX SPACING TABLE / ROZMIESTNENIE PRE 1LX

H (m)	Y1 (m)	Y2 (m)
2,75	6,6	17,5
3,00	6,1	17,9
3,50	5,7	18,0
4,00	4,7	17,5
4,50	3,5	17,1

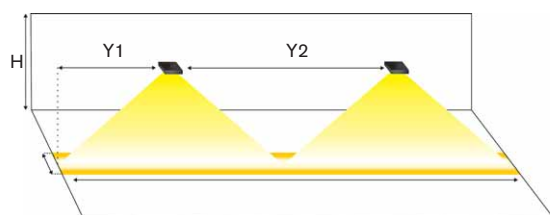

#### 1LX SPACING TABLE / ROZMIESTNENIE PRE 1LX

H (m)	X1 (m)	X2 (m)	Y1 (m)	Y2 (m)
2,75	4,0	10,5	3,0	9,6
3,00	3,1	11,3	2,3	9,8

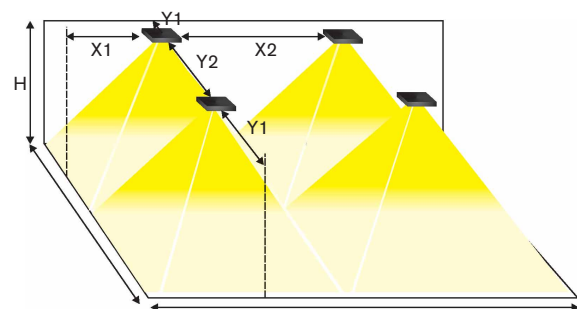

- Optional Wire rope suspension set (for the Item No. look up page No.230)
- Priplatkový lankový závesný set (pre obj.kód pozri str. 230)



MULTIPRIMA-AVA+2xLED



MULTIPRIMA-AVB+2xLED

## C.PRIMALUX-AP/-AV-LED / MULTIPRIMA-AP/-AV-LED



- Diffuser in AL frame including legend in accordance with ISO7010
- **It is not included in standard package. It must be ordered as separate item !**

- Viewing Distance: 30m
- Legend luminance  $>500\text{cd/m}^2$  (white)

- kryt svetidla v AL ráme s piktoqramom v súlade s ISO7010
- **nie je súčasťou štandardného balenia svetidla, musí byť objednané ako samostatná položka !**
- rozoznatelnosť piktoqramu: 30m
- jas piktoqramu  $>500\text{cd/m}^2$  (biela)

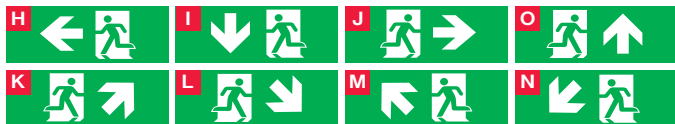

Item / Položka	Order Code / Objednávaci kód
Single sided diffuser with legend "H" Jednostranný kryt s pikto typ "H"	295-B-000-020-00-00
Single sided diffuser with legend "I" Jednostranný kryt s pikto typ "I"	295-B-000-021-00-00
Single sided diffuser with legend "J" Jednostranný kryt s pikto typ "J"	295-B-000-022-00-00
Single sided diffuser with legend "O" Jednostranný kryt s pikto typ "O"	295-B-000-023-00-00
Single sided diffuser with legend "K" Jednostranný kryt s pikto typ "K"	295-B-000-024-00-00
Single sided diffuser with legend "L" Jednostranný kryt s pikto typ "L"	295-B-000-025-00-00
Single sided diffuser with legend "M" Jednostranný kryt s pikto typ "M"	295-B-000-026-00-00
Single sided diffuser with legend "N" Jednostranný kryt s pikto typ "N"	295-B-000-027-00-00
Double sided diffuser with legend "H/J" Obojstranný kryt s pikto typ "H/J"	295-B-000-028-00-00
Double sided diffuser with legend "I" Obojstranný kryt s pikto typ "I"	295-B-000-029-00-00
Double sided diffuser with legend "O" Obojstranný kryt s pikto typ "O"	295-B-000-030-00-00
Double sided diffuser with legend "K/M" Obojstranný kryt s pikto typ "K/M"	295-B-000-031-00-00
Double sided diffuser with legend "L/N" Obojstranný kryt s pikto typ "L/N"	295-B-000-032-00-00

Available in black RAL9005 colour

Order code on demand

Dostupné aj čiernej farbe RAL9005  
obj.kód ba požiadanie

### Options: / Príplatky:

- Wire rope suspension set including all:
  - 2pcs of tool-free adjustable wire holders located on the fixture body for rapid mounting and adjustment of suspension length
  - 2pcs of suspension steel wire ropes 0.8m long
  - 1pc of ceiling power outlets
  - 1.5m long cord

### • Závesný lankový set obsahuje:

- 2ks nastaviteľných závesov pre nastavenie požadovanej dĺžky závesu
- 2ks závesných laniek dĺžky 0,8m
- 1ks sieťovej prípojnej krabičky na strop
- číry prírodný elektrický kábel 1,5m dlhý

Optional Item / Príplatok	Order Code / objednávaci kód
Wire rope suspension kit 1.5 m long	295-B-206-001-00-00
Závesná lanková sada dĺžky 1,5 m	295-B-206-001-00-00





## C.PRIMALUX-AV-LED / MULTIPRIMA-AV-LED

Page No.162

### AUTOTEST -AT NM/M

Type	Version	Duration	Light Source	Light Flux / Emerg.mode	Battery	Order Code	Weight
MULTIPRIMA-AV-AT.1h	NM/M	1h	18xMidPower LEDs	N.A.	NiMh 4,8V/1,1Ah	295-B-400-01-00-00	1,6 kg
MULTIPRIMA-AV-AT.1h	NM/M	1h	18xMidPower LEDs	N.A.	LiFePo4 6,4V/1,0Ah	295-B-400-04-00-00	1,6 kg
MULTIPRIMA-AV-AT.3h	NM/M	3h	18xMidPower LEDs	N.A.	NiMh 4,8V/3,0Ah	295-B-401-02-00-00	1,7 kg
MULTIPRIMA-AVA-AT+2xLED.1h	NM/M	1h	18x LEDs + 2x LEDs	- / 100 lm	NiMh 4,8V/1,1Ah	295-B-402-01-00-00	1,7 kg
MULTIPRIMA-AVA-AT+2xLED.1h	NM/M	1h	18x LEDs + 2x LEDs	- / 100 lm	LiFePo4 6,4V/1,0Ah	295-B-402-04-00-00	1,7 kg
MULTIPRIMA-AVA-AT+2xLED.3h	NM/M	3h	18x LEDs + 2x LEDs	- / 100 lm	NiMh 4,8V/3,0Ah	295-B-403-02-00-00	1,8 kg
MULTIPRIMA-AVB-AT+2xLED.1h	NM/M	1h	18x LEDs + 2x LEDs	- / 100 lm	NiMh 4,8V/1,1Ah	295-B-404-01-00-00	1,7 kg
MULTIPRIMA-AVB-AT+2xLED.1h	NM/M	1h	18x LEDs + 2x LEDs	- / 100 lm	LiFePo4 6,4V/1,0Ah	295-B-404-04-00-00	1,7 kg
MULTIPRIMA-AVB-AT+2xLED.3h	NM/M	3h	18x LEDs + 2x LEDs	- / 100 lm	NiMh 4,8V/3,0Ah	295-B-405-02-00-00	1,8 kg

### DALI

Type	Version	Duration	Light Source	Light Flux / Emergency mode	Battery	Order Code	Weight
MULTIPRIMA-AV-DALI.3h	NM/M	3h	18xMidPower LEDs	N.A.	NiMh 4,8V/2,1Ah	295-B-427-02-00-00	1,6 kg

Page No.166

### CENTRALTEST -ATXL ELMAX-LOOK

Type	Version	Duration	Light Source	Light Flux/Emerg.mode	Battery	Order Code	Weight
MULTIPRIMA-AV-ATXL.1h	NM/M	1h	18xMidPower LEDs	N.A.	NiMh 4,8V/1,1Ah	295-B-406-01-00-00	1,6 kg
MULTIPRIMA-AV-ATXL.1h	NM/M	1h	18xMidPower LEDs	N.A.	LiFePo4 6,4V/1,0Ah	295-B-406-04-00-00	1,6 kg
MULTIPRIMA-AV-ATXL.3h	NM/M	3h	18xMidPower LEDs	N.A.	NiMh 4,8V/3,0Ah	295-B-407-02-00-00	1,7 kg
MULTIPRIMA-AVA-ATXL+2xLED.1h	NM/M	1h	18x LEDs + 2x LEDs	- / 100 lm	NiMh 4,8V/1,1Ah	295-B-408-01-00-00	1,7 kg
MULTIPRIMA-AVA-ATXL+2xLED.1h	NM/M	1h	18x LEDs + 2x LEDs	- / 100 lm	LiFePo4 6,4V/1,0Ah	295-B-408-04-00-00	1,7 kg
MULTIPRIMA-AVA-ATXL+2xLED.3h	NM/M	3h	18x LEDs + 2x LEDs	- / 100 lm	NiMh 4,8V/3,0Ah	295-B-409-02-00-00	1,8 kg
MULTIPRIMA-AVB-ATXL+2xLED.1h	NM/M	1h	18x LEDs + 2x LEDs	- / 100 lm	NiMh 4,8V/1,1Ah	295-B-410-01-00-00	1,7 kg
MULTIPRIMA-AVB-ATXL+2xLED.1h	NM/M	1h	18x LEDs + 2x LEDs	- / 100 lm	LiFePo4 6,4V/1,0Ah	295-B-410-04-00-00	1,7 kg
MULTIPRIMA-AVB-ATXL+2xLED.3h	NM/M	3h	18x LEDs + 2x LEDs	- / 100 lm	NiMh 4,8V/3,0Ah	295-B-411-02-00-00	1,8 kg

Page No.168

### Wireless CENTRALTEST ELMAX-ATZB

Type	Version	Duration	Light Source	Light / Emergency mode	Battery	Order Code	Weight
MULTIPRIMA-AV-ATZB.1h	NM/M	1h	18xMidPower LEDs	N.A.	NiMh 4,8V/1,1Ah	295-B-412-01-00-00	1,6 kg
MULTIPRIMA-AV-ATZB.3h	NM/M	3h	18xMidPower LEDs	N.A.	NiMh 4,8V/3,0Ah	295-B-413-02-00-00	1,7 kg
MULTIPRIMA-AVA-ATZB+2xLED.1h	NM/M	1h	18x LEDs + 2x LEDs	- / 100 lm	NiMh 4,8V/1,1Ah	295-B-414-01-00-00	1,7 kg
MULTIPRIMA-AVA-ATZB+2xLED.3h	NM/M	3h	18x LEDs + 2x LEDs	- / 100 lm	NiMh 4,8V/3,0Ah	295-B-415-02-00-00	1,8 kg
MULTIPRIMA-AVB-ATZB+2xLED.1h	NM/M	1h	18x LEDs + 2x LEDs	- / 100 lm	NiMh 4,8V/1,1Ah	295-B-416-01-00-00	1,7 kg
MULTIPRIMA-AVB-ATZB+2xLED.3h	NM/M	3h	18x LEDs + 2x LEDs	- / 100 lm	NiMh 4,8V/3,0Ah	295-B-417-02-00-00	1,8 kg

Page No.174

### CENTRAL BATTERY (CBS)

Type	Version	Light Source	Light Flux	Order Code	Weight
C.PRIMALUX-AV 230V AC/DC	CBS NON-ADDRESSABLE	18xMidPower LEDs	N.A.	295-B-418-00-00-00	1,3 kg
C.PRIMALUX-AV 24V AC/DC	CBS NON-ADDRESSABLE	18xMidPower LEDs	N.A.	295-B-419-00-00-00	1,3 kg
C.PRIMALUX-AVA+2xLED 230V AC/DC	CBS NON-ADDRESSABLE	18x LEDs + 2x LEDs	100 lm	295-B-420-00-00-00	1,4 kg
C.PRIMALUX-AVA+2xLED 24V AC/DC	CBS NON-ADDRESSABLE	18x LEDs + 2x LEDs	100 lm	295-B-421-00-00-00	1,4 kg
C.PRIMALUX-AVB+2xLED 230V AC/DC	CBS NON-ADDRESSABLE	18x LEDs + 2x LEDs	100 lm	295-B-422-00-00-00	1,4 kg
C.PRIMALUX-AVB+2xLED 24V AC/DC	CBS NON-ADDRESSABLE	18x LEDs + 2x LEDs	100 lm	295-B-423-00-00-00	1,4 kg

Page No.170

### Addressable CENTRAL BATTERY (CBS) -ATXP ELMAX-PATROLUX

Type	Version	Light Source	Light Flux	Order Code	Weight
C.PRIMALUX-AV-ATXPR 230V AC/DC	ATXP CBS ADDRESSABLE	18xMidPower LEDs	N.A.	295-B-424-00-00-00	1,4 kg
C.PRIMALUX-AVA-ATXPR+2xLED 230V AC/DC	ATXP CBS ADDRESSABLE	18x LED + 2x LED	100 lm	295-B-425-00-00-00	1,5 kg
C.PRIMALUX-AVB-ATXPR+2xLED 230V AC/DC	ATXP CBS ADDRESSABLE	18x LED + 2x LED	100 lm	295-B-426-00-00-00	1,5 kg

Look up pages No. 328-335 for 1lx Spacing tables  
Pozri str. 328-335 pre rozmiestnenie svietidiel na dosiahnutie 1lx