

C.NORMALUX-LED / MULTINORMA-LED

ALSO FOR HIGH CEILING >4m
AJ PRE VYSOKÉ STROPY >4m

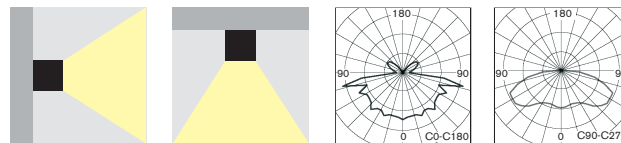
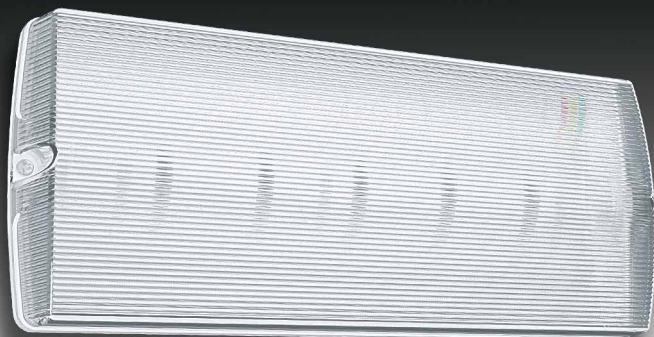

- Equisite solid design surface mounted powerful fixture with perfect light distribution for non-maintained (NM), non-maintained/maintained (NM/M) or centralised (C) emergency lighting available in all following versions:
 - HEIGHT CEILING Application** version equipped with 9xHighPower LEDs
 - AUTOTEST** (-AT)
 - CENTRAL BATTERY** (C.NORMALUX) for **non-addressable CBS** (look up also page No.174)
- Conforming to the requirement of EN60598-2-22, EN1838, EN62034
- Design: PC impact resistant body
- kompletné a elegantné výkonné núdzové svetlo s perfektnou distribúciou svetla pre netvalé (NM) alebo pre trvalé/netvalé (NM/M) alebo (C) centrálné napájané núdzové osvetlenie dostupné vo verziách pre:
 - verzia pre aplikáciu VO VEĽKÝCH VÝŠKACH** vybavená **9xHighPower LED**
 - AUTOTEST** (-AT)
 - CENTRAL BATTERY** (C.NORMALUX) pre **neadresovateľné CBS** (pozri str. 174)
- spĺňa požiadavky európskej normy EN 60598-2-22, EN1838, EN62034
- konštrukcia: teleso z nerozbitného PC

← → 32m



STANDARD FEATURES

ŠTANDARDNÁ VÝBAVA

- HighPower LEDs 120lm/W, 5000K (Lumileds) with the lifetime Min 100.000h
- Set of self-adhesive legends (H+I+J) complying ISO7010
- Special mirror effect reflector
- Addressable CENTRALTEST communication module (for ATXL, ATXP versions only)
- LEDs indicating both presence of power supply and signaling failures
- TEST button
- výkonné LED 120lm/W, 5000K (Lumileds) so životnosťou min 100000hod
- sada samolepiacich piktogramov H+I+J v súlade s ISO7010
- špeciálny odrazový reflektor so zrkadlovým efektom
- adresovateľný CENTRALTEST komunikačný modul (len pre ATXL, ATXP verzie)
- signalizácia LED a TEST tlačítko



OPTIONAL ACCESSORIES

PRÍPLATKY

- Suspended plexi with single sided or double sided legend (look up page 282)
- Wall or ceiling mounting brackets (look up page No.282)
- Protective steel cage (look up page No.282)
- závesné plexi s jednostranným alebo obojstranným piktogramom (pozri str.282)
- nástenná, stropná alebo stropná závesná konzola (pozri str.282)
- ochranný kovový kôš (pozri str.282)



Optional Suspended plexi with Legends
Príplatkové závesné plexi s piktogramom
(look up also page No.282)



Optional Brackets and Protective Steel Cage
Príplatkové konzoly a ochranná mrieža
(look up also page No.282)

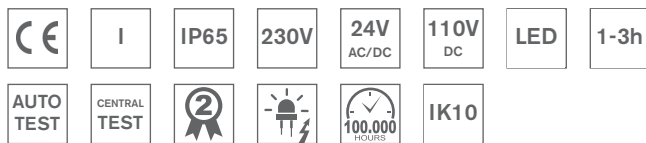

Input Power (5xLED):

- 11,5W / 15,3VA (maintained M)
- 2,2W / 5,7VA (non-maintained NM)
- 8,5W / 10,9VA (CBS)

Input Power (3xLED):

- 8W / 11,8VA (maintained M)
- 2,7W / 5,5VA (non-maintained NM)
- 5,7W / 8,7VA (CBS)

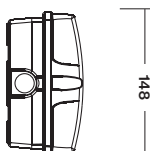
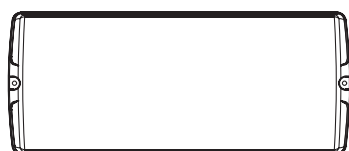

360

80

148

Parking garage area emergency lighting application

C.NORMALUX-LED / MULTINORMA-LED



NM/M							
Type	Version	Duration	Light Source	Light Flux / Emergency mode	Battery	Order Code	Weight
MULTINORMA 3xLED.1h	NM/M	1h	3x HighPower LED	342 lm / 342 lm	NiMh 4,8V/2,1Ah	252-B-14	1,5 kg
MULTINORMA 3xLED.3h	NM/M	3h	3x HighPower LED	342 lm / 342 lm	NiMh 4,8V/4,0Ah	252-B-15	1,6 kg

Page No.162

AUTOTEST -AT NM/M

Type	Version	Duration	Light Source	Light Flux / Emergency mode	Battery	Order Code	Weight
MULTINORMA-AT 3xLED.1h	NM/M	1h	3x HighPower LED	457 lm / 414 lm	NiMh 4,8V/3,0Ah	252-B-16	1,5 kg
NORMALUX-AT 9xLED.1h	NM	1h	9x HighPower LED	- / 1240 lm *	NiMh 9,6V/4,0Ah	252-B-32	1,8 kg

AUTOTEST DALI

Type	Version	Duration	Light Source	Light Flux / Emergency mode	Battery	Order Code	Weight
MULTINORMA-AT DALI 8xLED.1h	NM/M	1h	8x MidPower LED	180 lm / 180 lm	NiMh 2,4V/2,2Ah	252-B-41	1,5 kg

DALI (CBS)

Type	Version	Light Source	Light Flux	Order Code	Weight
C.NORMALUX-DALI 5xLED/230V AC/DC	CBS NON-ADDRESSABLE	5x HighPower LED	700 lm	252-B-51	1,2 kg

Page No.174

CENTRAL BATTERY (CBS)

Type	Version	Light Source	Light Flux	Order Code	Weight
C.NORMALUX 3xLED/230V AC/DC	CBS NON-ADDRESSABLE	3x HighPower LED	450 lm	252-B-19	1,2 kg
C.NORMALUX 3xLED/24V AC/DC	CBS NON-ADDRESSABLE	3x HighPower LED	450 lm	252-B-28	1,2 kg
C.NORMALUX 5xLED/230V AC/DC	CBS NON-ADDRESSABLE	5x HighPower LED	760 lm	252-B-20	1,2 kg
C.NORMALUX 5xLED/24V AC/DC	CBS NON-ADDRESSABLE	5x HighPower LED	760 lm	252-B-31	1,2 kg
C.NORMALUX 6xLED/110V DC	CBS NON-ADDRESSABLE	6x HighPower LED	858 lm	252-B-44	1,2 kg
C.NORMALUX 9xLED/230V AC/DC	CBS NON-ADDRESSABLE	9x HighPower LED	1240 lm *	252-B-34	1,2 kg

* All 9xHighPower LED versions are designed for **Heigh Ceiling Application** (for 1lx spacing tables look up also page No.328-335)

* všetky 9xHighPower LED verzie sú určené **pre aplikáciu vo vysokých výškach** (pozri aj str. 328+335 pre 1lx tabuľky)



- Suspended plexi with single or double sided legend complying ISO7010
- Viewing Distance: 35m
- závesné plexi s jednostranným alebo obojstranným piktogramom v súlade s ISO7010
- rozoznatelnosť piktogramu: 35m

Optional Item / Príplatok	Order Code / Objednávaci kód
Suspended plexi H/I doublesided / obojstranné	252-B-23-05
Suspended plexi I doublesided / obojstranné	252-B-23-01
Suspended plexi H singlesided / jednostranné	252-B-23-06
Suspended plexi I singlesided / jednostranné	252-B-23-04
Suspended plexi J singlesided / jednostranné	252-B-23-07
Suspended plexi K/M doublesided / obojstranné	252-B-23-08
Suspended plexi L/N doublesided / obojstranné	252-B-23-09
Suspended plexi K singlesided / jednostranné	252-B-23-10
Suspended plexi L singlesided / jednostranné	252-B-23-11
Suspended plexi M singlesided / jednostranné	252-B-23-12
Suspended plexi N singlesided / jednostranné	252-B-23-13
Suspended plexi O singlesided / jednostranné	252-B-23-16
Suspended plexi O doublesided / obojstranné	252-B-23-17
Suspended plexi Z1 doublesided / obojstranné	252-B-23-21
Suspended plexi Z2 doublesided / obojstranné	252-B-23-22

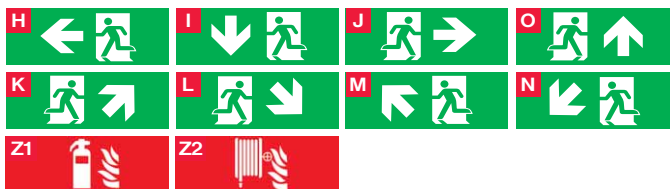
**Options:**

- Wall / Ceiling / Pendant mounting bracket
- Protective Steel Cage

Príplatky:

- nástenná / stropná / závesná konzola
- ochranný kôš

Optional Item : Príplatok :	Order Code : objednávaci kód :
Wall mounting bracket / nástenná konzola RAL9003	252-B-22-00
Ceiling mounting bracket / stropná konzola RAL9003	252-B-22-01-01
Ceiling mounting bracket / stropná konzola RAL9006	252-B-22-01
Pendant bracket 0,5m / závesná konzola 0,5m RAL9003	252-B-22-12-01
Pendant bracket 0,5m / závesná konzola 0,5m RAL9006	252-B-22-12-02
Pendant bracket 0,65m / závesná konz. 0,65m RAL9006	252-B-22-09
Pendant bracket 1,0m / závesná konzola 1,0m RAL9003	252-B-22-10-01
Pendant bracket 1,5m / závesná konzola 1,5m RAL9003	252-B-22-11-01
Protective steel cage / ochranný kôš RAL9003	252-B-22-05

Parking garage area emergency lighting application

C.NORMALUX-LED / MULTINORMA-LED

Light source	LED 5000K
Installed load	11.5W/15.3VA (maintained M)
5xLED	2.2W/5.7VA (non-maintained NM)
	8.5W/10.9VA (CBS)
Installed load	8W/11.8VA (maintained M)
3xLED	2.7W/5.5VA (non-maintained NM)
	5.7W/8.7VA (CBS)
Protection type	IP65
Housing material	Impact resistant polycarbonate
Viewing distance	32-35m



Project:
Shopping Mall AUPARK
 Bratislava (SK)
 Project by:
ECO-LOGIC s.r.o.
www.ecologic.sk

Suspended Bracket Mounted Emergency Luminaire

MULTINORMA-LED



Project:
Shopping Mall AUPARK
Bratislava (SK)
Project by:
ECO-LOGIC s.r.o.
www.ecologic.sk

Light source	LED 5000K
Installed load	11.5W/15.3VA (maintained M)
5xLED	2.2W/5.7VA (non-maintained NM)
	8.5W/10.9VA (CBS)
Installed load	8W/11.8VA (maintained M)
3xLED	2.7W/5.5VA (non-maintained NM)
	5.7W/8.7VA (CBS)
Protection type	IP65
Housing material	Impact resistant polycarbonate
Viewing distance	32-35m

Suspended Bracket Mounted Emergency Luminaire

MULTINORMA-LED



Project:
Shopping Mall AUPARK
Bratislava (SK)
Project by:
ECO-LOGIC s.r.o.
www.ecologic.sk